

## WZÓR 1 - PROFIL JODEŁKA

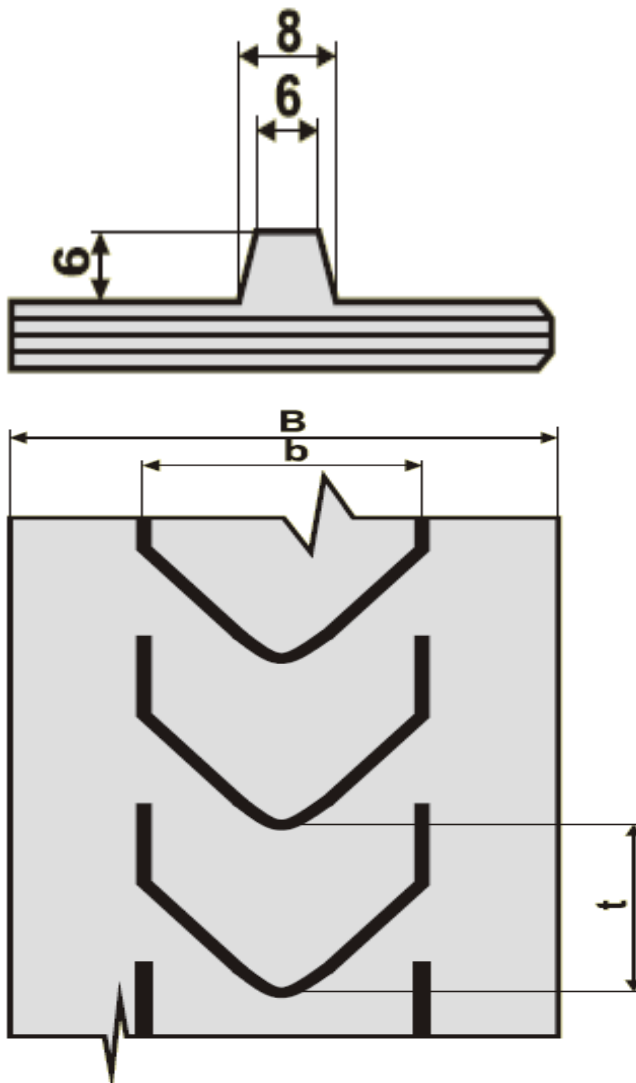

<b>B mm</b>	<b>b mm</b>	<b>t mm</b>
400 ÷ 800	340	280

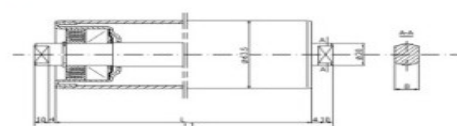
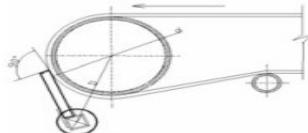
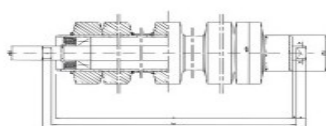

## WZÓR 2 - PROFIL JODEŁKA

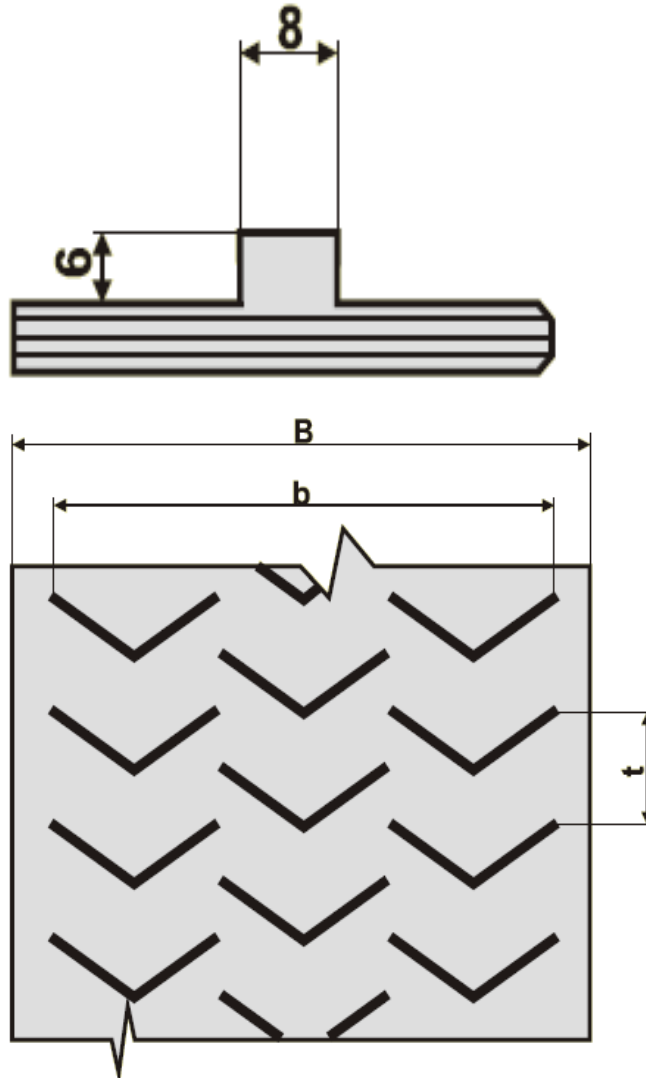

<b>B mm</b>	<b>b mm</b>	<b>t mm</b>
800 ÷ 1000	715	150

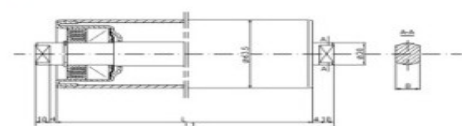
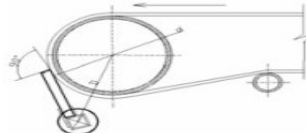
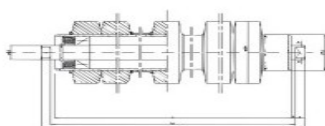

## WZÓR 3 - PROFIL JODEŁKA

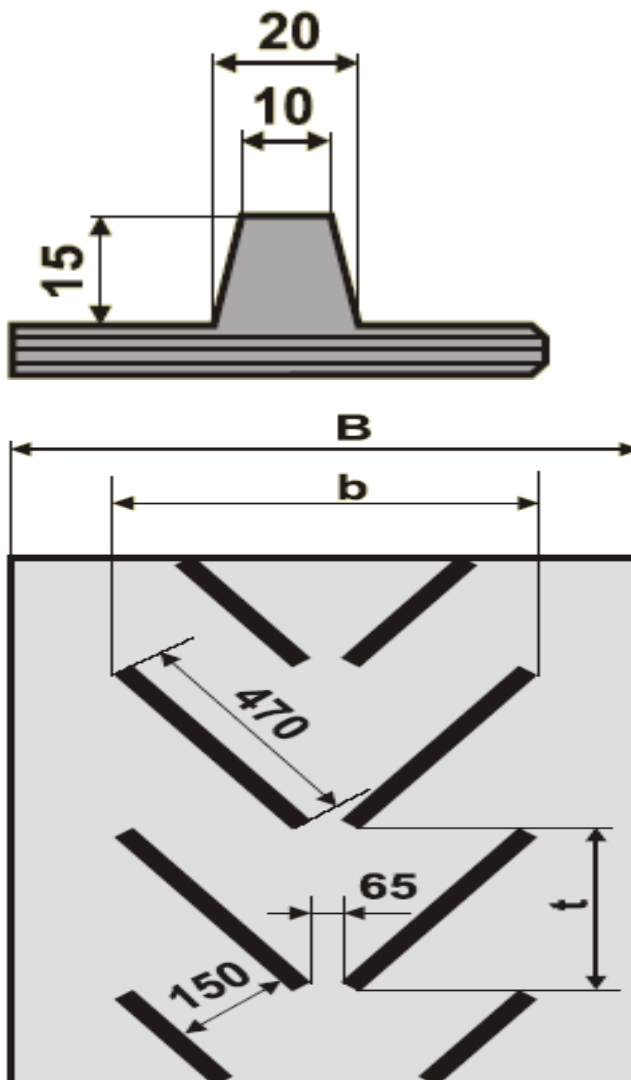

<b>B mm</b>	<b>b mm</b>	<b>t mm</b>
600 ÷ 800	550	300



**HandlexPol**

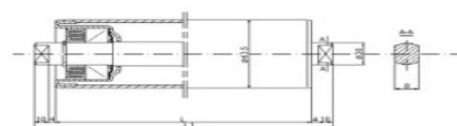
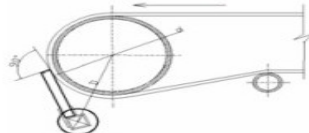
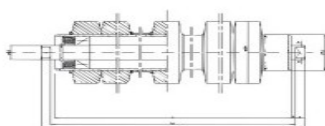

## WZÓR 4 – PROFIL JODEŁKA

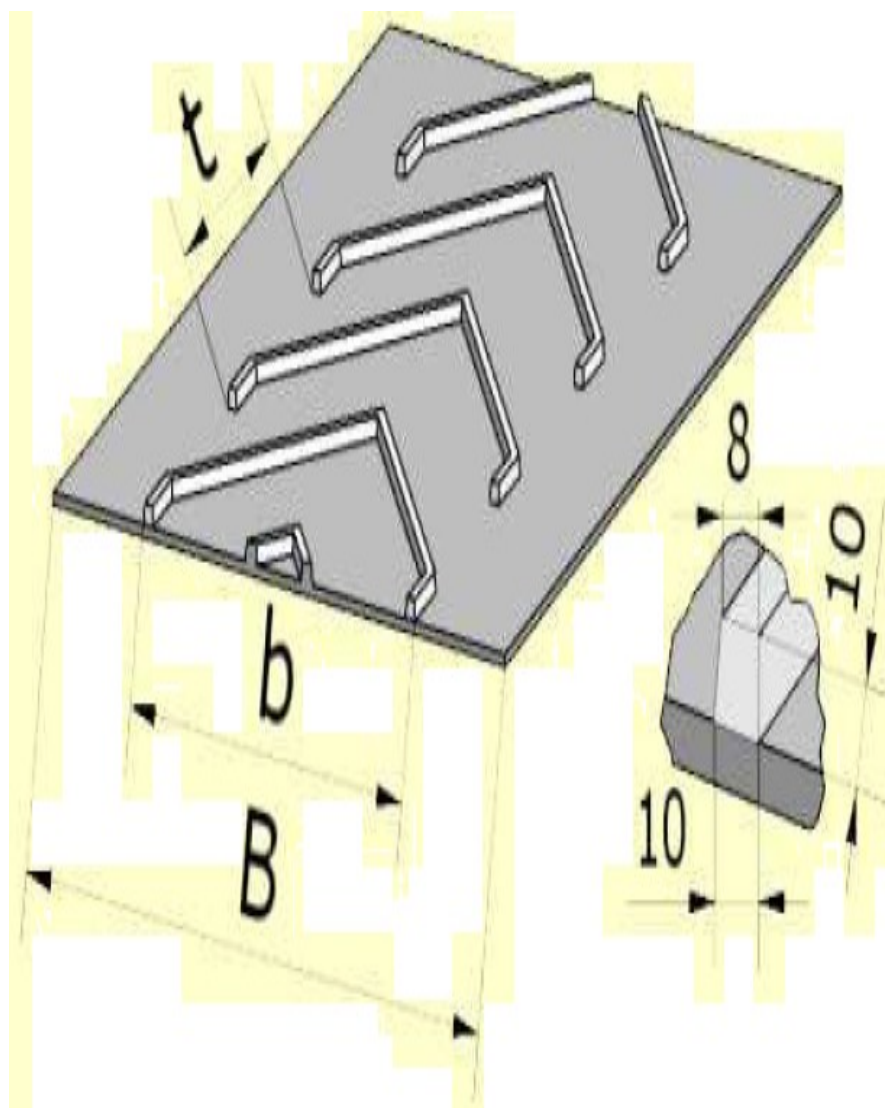

B mm	b mm	t mm	Zalecane parametry pracy		
400 + 650	300	200	Minimalna średnica bębnow [mm]	Max efektywny kąt pracy	Możliwość pracy w niecce
			200	30°	TAK

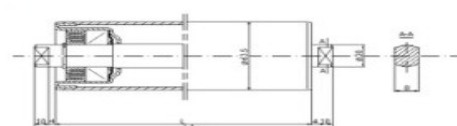
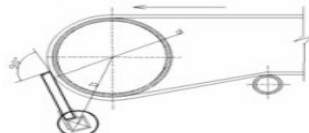
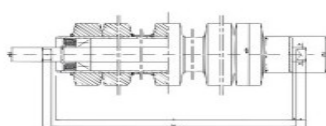
## WZÓR 5 – PROFIL JODEŁKA

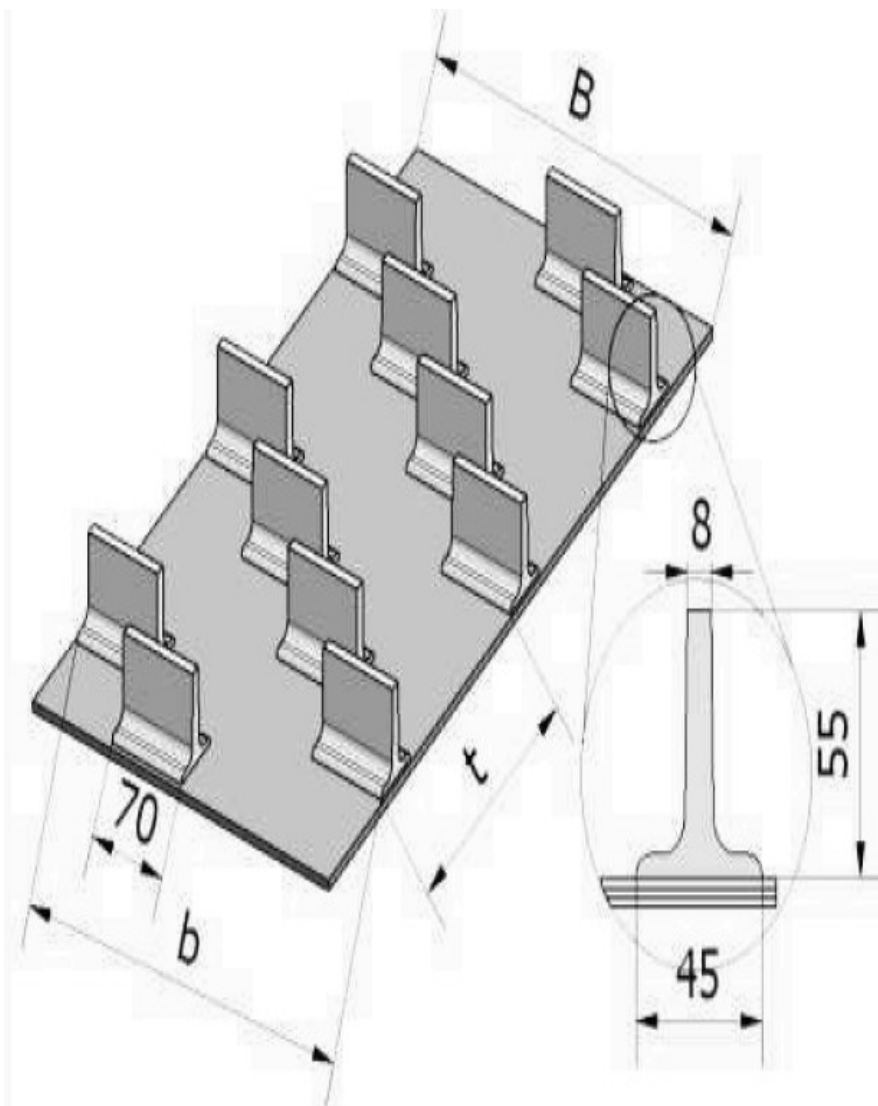

B mm	b mm	t mm	Zalecane parametry pracy		
300 + 650	295	200	Minimalna średnica bębnow [mm]	Max efektywny kąt pracy	Możliwość pracy w niecce
			250	40°	TAK



**HandlexPol**

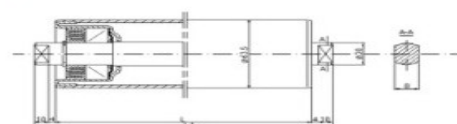
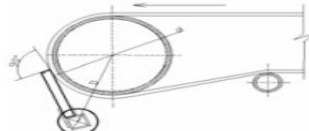
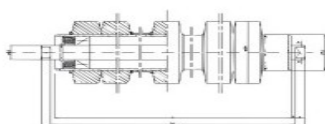



## WZÓR 6 – PROFIL JODEŁKA 15°

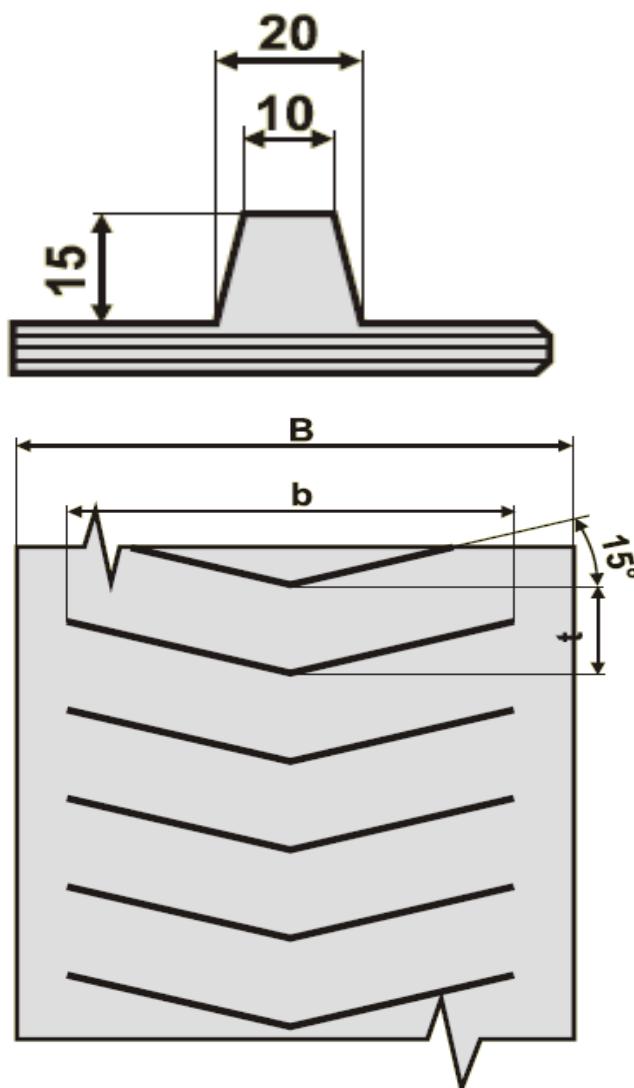

<b>B mm</b>	<b>b mm</b>	<b>t mm</b>
1000	980	103
1200	1120	



**HandlexPol**

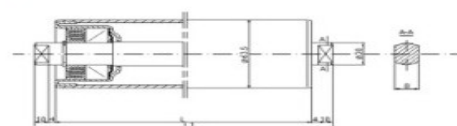
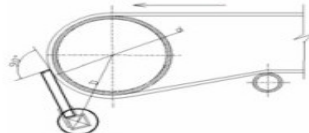
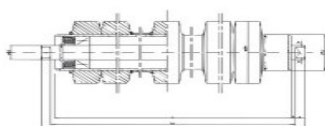

## WZÓR 7 – PROFIL JODEŁKA 15° Z LISTWAMI BOCZNYMI

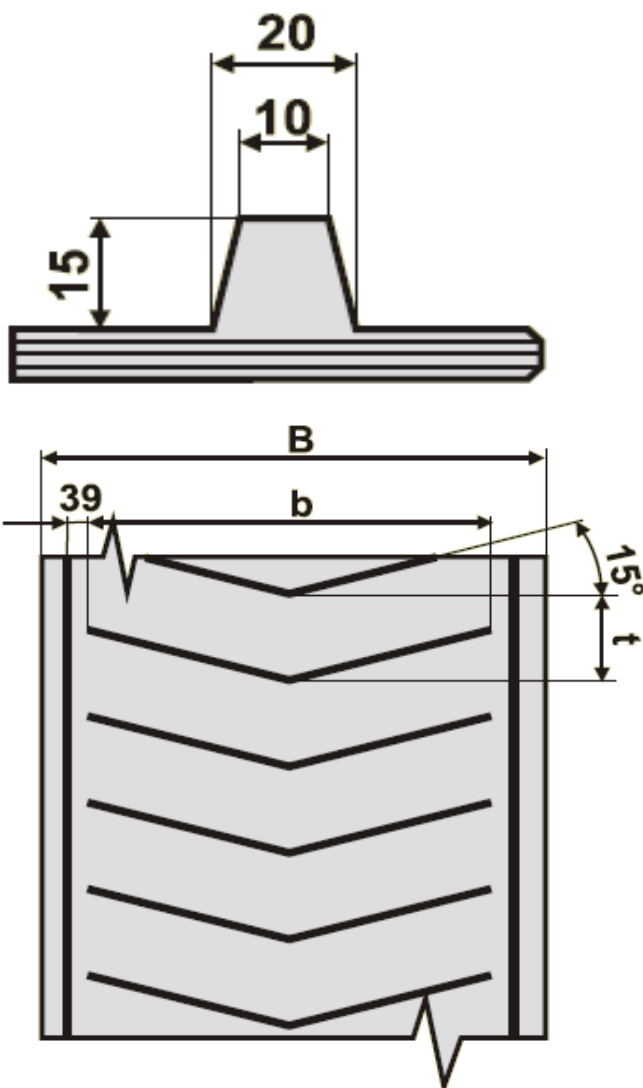

B mm	b mm	t mm	Zalecane parametry pracy		
300	290	103	Minimalna średnica bębnow [mm]	Max efektywny kąt pracy	Możliwość pracy w niecce
1200	1198	300	300	30°	TAK
1400	1198	300			



**HandlexPol**

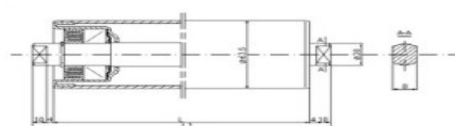
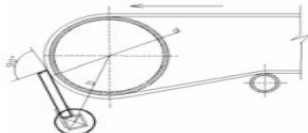
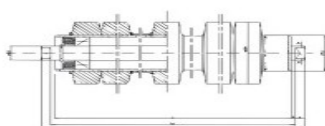

## WZÓR 8 – PROFIL JODEŁKA 35°

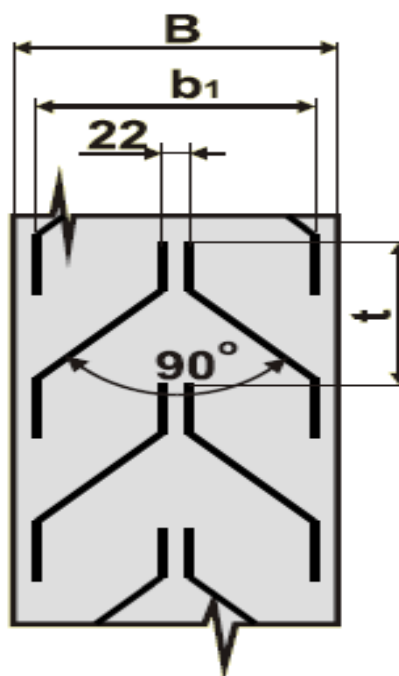
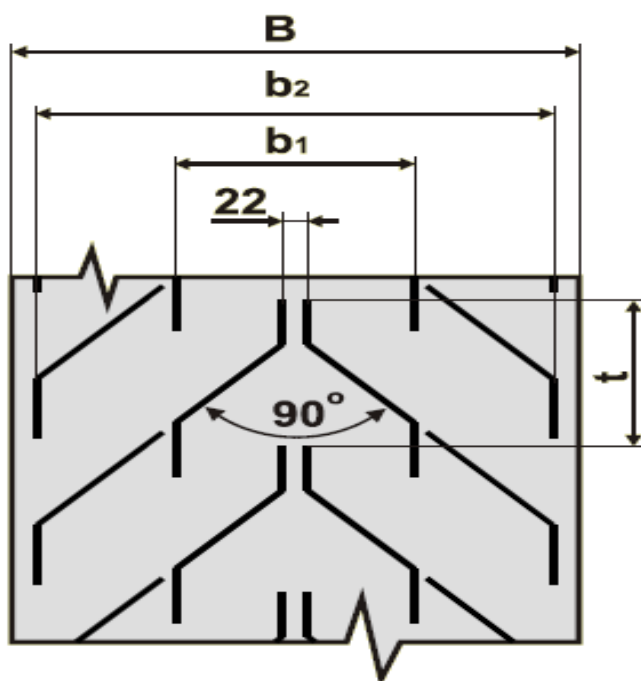
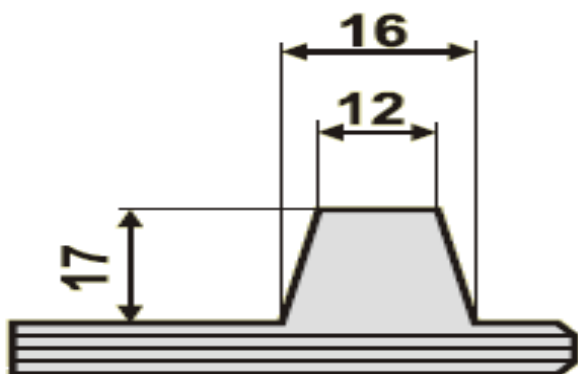

B mm	b <sub>1</sub> mm	b <sub>2</sub> mm	t mm
400 + 650	375		250
800		720	280
1000 + 1200		850	300

Zalecane parametry pracy		
Minimalna średnica bębnow [mm]	Max efektywny kąt pracy	Możliwość pracy w niecce
250	30°	TAK

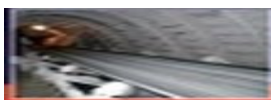

**HandlexPol**

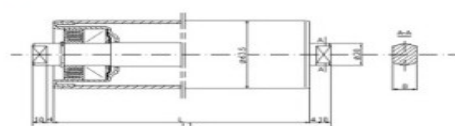
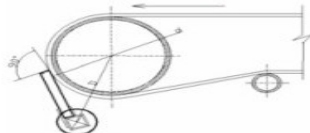
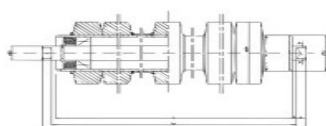



## WZÓR 9 – PROFIL JODEŁKA 35° DZIELONA

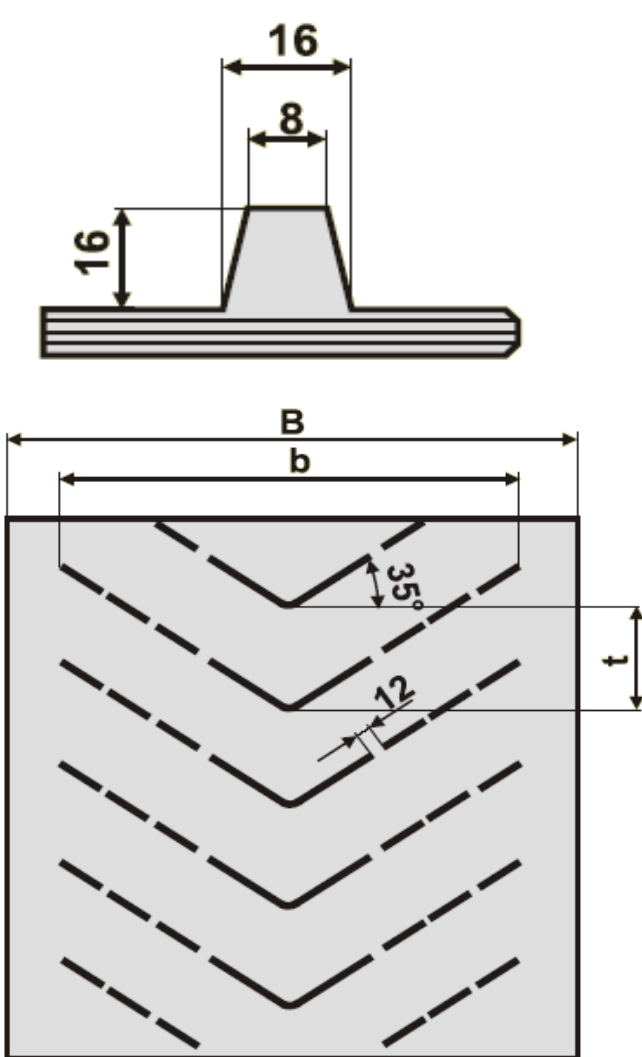

B mm	b mm	t mm
300 + 400	265 316	200
500 + 600	415 465	
650	565 615	
800 + 1000	715 770	
1000 + 1200	860 1010	

Zalecane parametry pracy		
Minimalna średnica bębnow [mm]	Max efektywny kąt pracy	Możliwość pracy w nleccie
250	30°	TAK

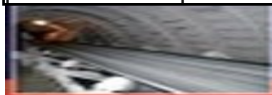

**HandlexPol**

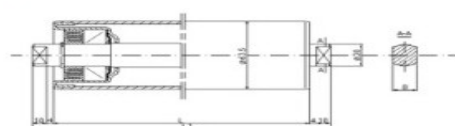
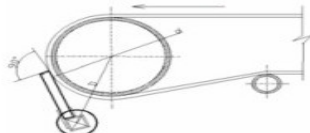
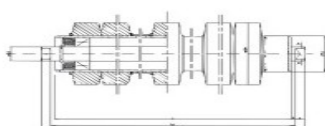

## WZÓR 10 – PROFIL JODEŁKA 35° DZIELONA

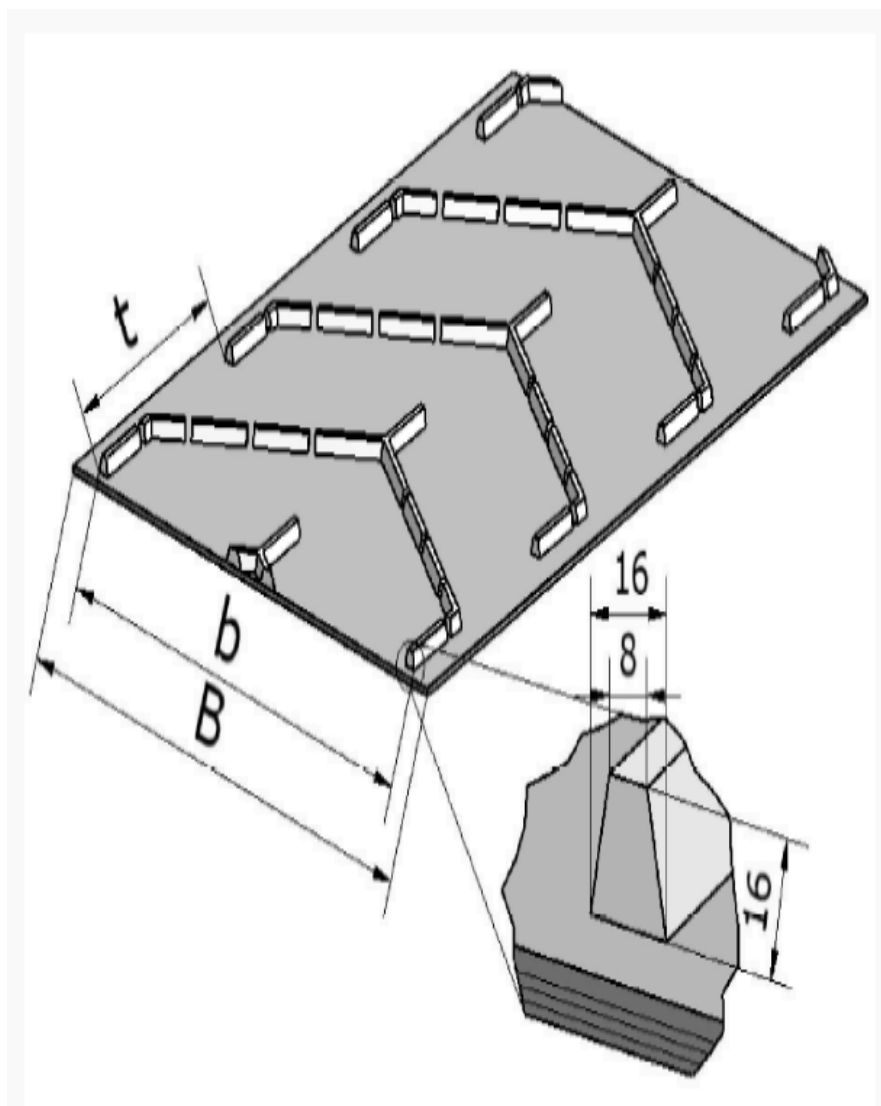

B mm	b mm	t mm	Zalecane parametry pracy		
300 + 500	230 285	250	Minimalna średnica bębnow [mm]	Max efektywny kąt pracy	Możliwość pracy w niecce
500 + 650	380 430	300	250	30°	TAK
800	526 580	300			
1000	726	250			
1200	875	220			
	1020	300			



HandlexPol

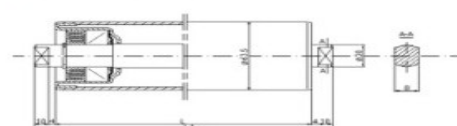
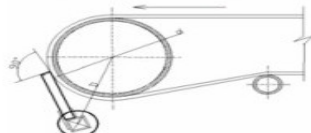
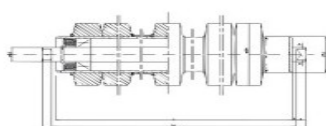

## WZÓR 11 – PROFIL JODEŁKA 35° DZIELONA WYSOKA

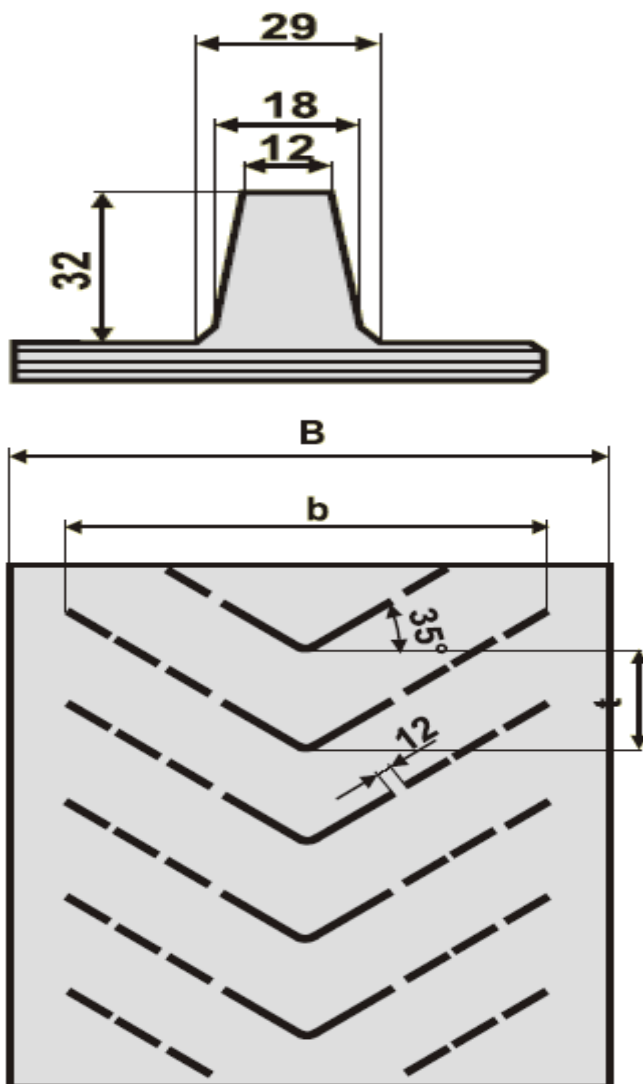

B mm	b mm	t mm	Zalecane parametry pracy		
400 500 + 600 650 800 + 1000	325 472 620 770	200	Minimalna średnica bębnow [mm]	Max efektywny kąt pracy	Możliwość pracy w niecce
			315	40°	TAK

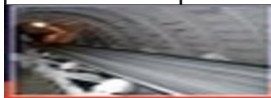

**HandlexPol**

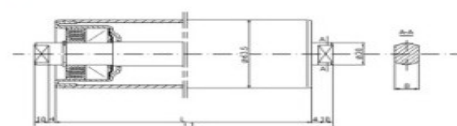
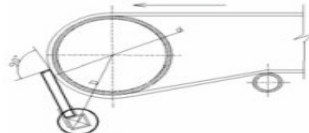
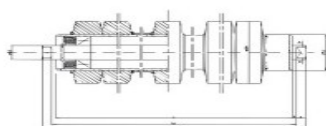



**WZÓR 12 – PROFIL JODEŁKA 35° DZIELONA Z LISTWAMI BOCZNYMI**

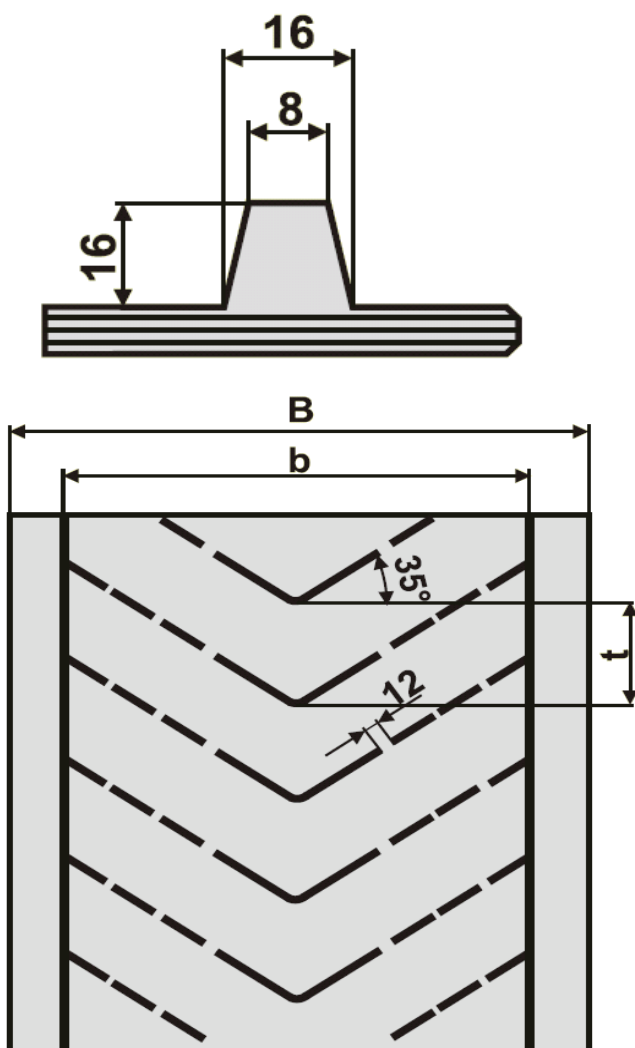

B mm	b mm	t mm
350 + 500	290 405	200
500 + 600	445 550	
650 + 800	600 700	
750 + 900	755 855	
1000+1200	905 1000	

Zalecane parametry pracy		
Minimalna średnica bębnow [mm]	Max efektywny kąt pracy	Możliwość pracy w niecce
250	30°	TAK



**HandlexPol**

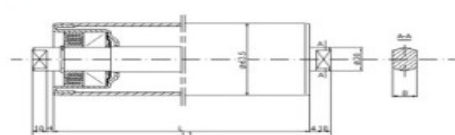
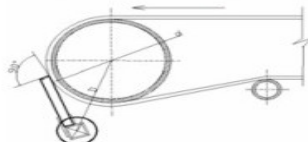
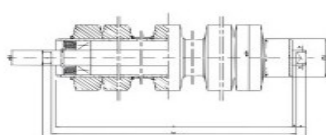



## WZÓR 13 – PROFIL JODEŁKA 45°

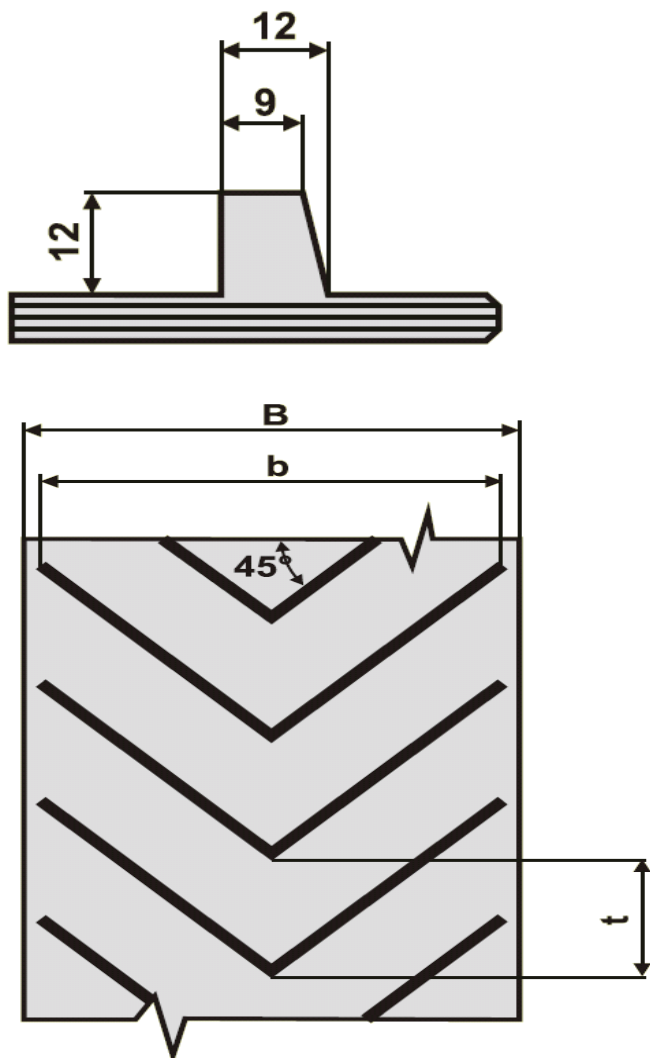

B mm	b mm	t mm
350+650	462	122

Zalecane parametry pracy		
Minimalna średnica bębnow [mm]	Max efektywny kąt pracy	Możliwość pracy w niecce
200	30°	NIE



**HandlexPol**

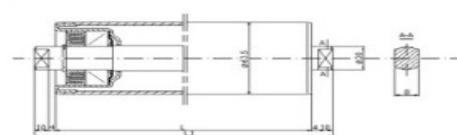
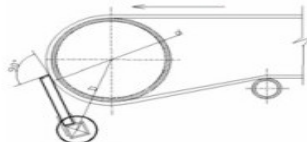
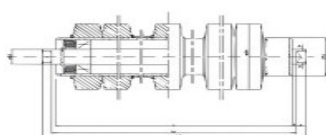

## WZÓR 14 – PROFIL JODEŁKA WYSOKA 45°

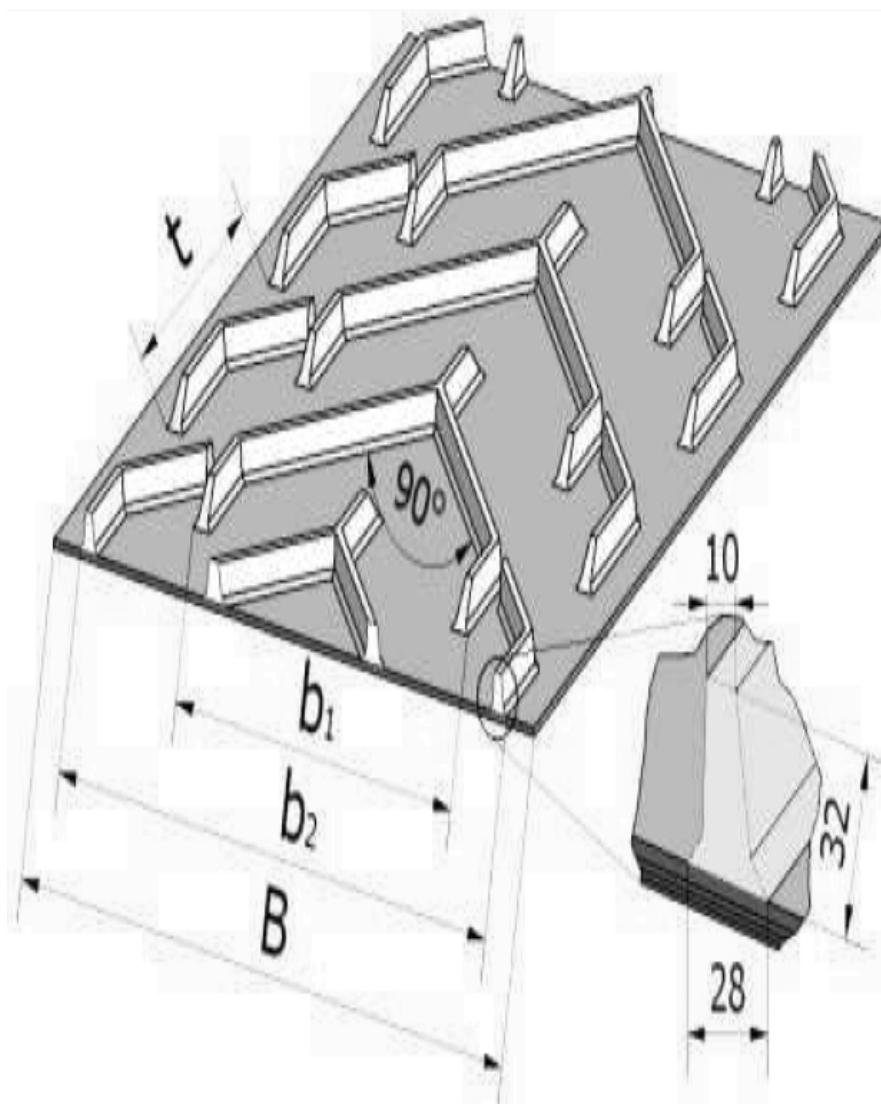

B mm	b <sub>1</sub> mm	b <sub>2</sub> mm	t mm	Zalecane parametry pracy		
500	458	-	300	Minimalna średnica bębnow [mm]	Max efektywny kąt pracy	Możliwość pracy w niecce
650	610	-	400	315	40°	TAK
800	458	710	300			
1000	610	862	350			



HandlexPol

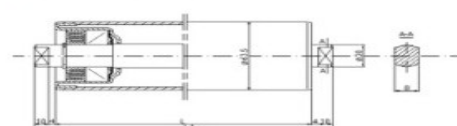
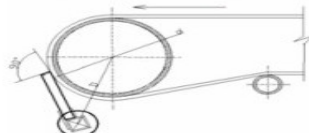
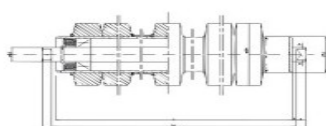

## WZÓR 15 - PROFIL U

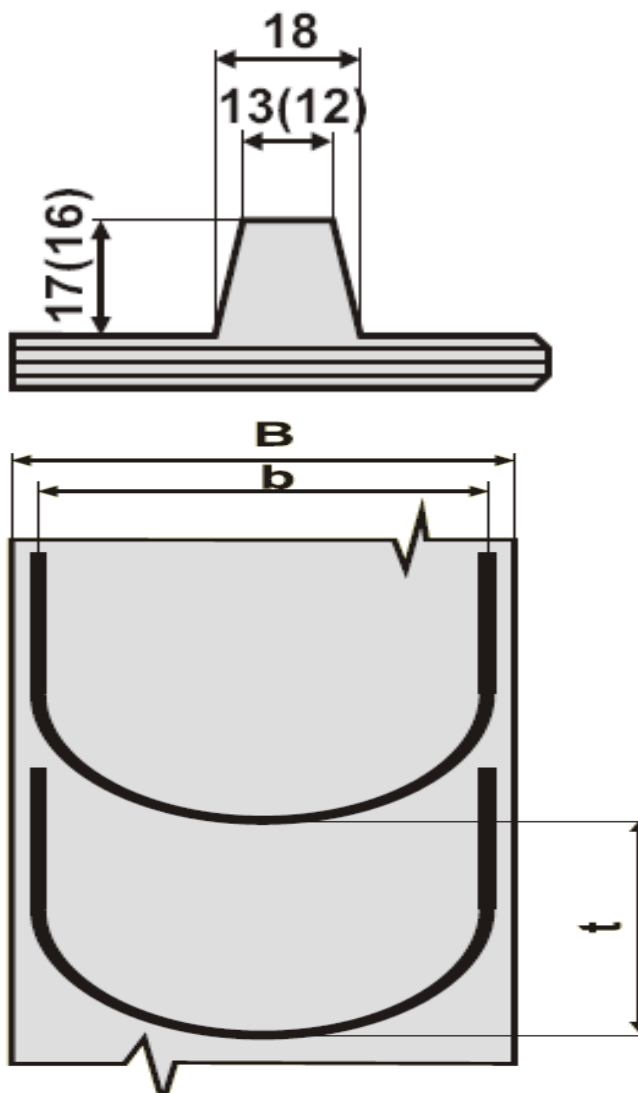

<b>B mm</b>	<b>b mm</b>	<b>t mm</b>
500	398	600
650	565	580



**HandlexPol**

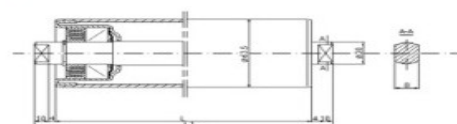
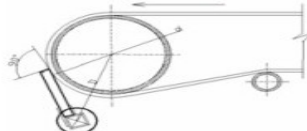
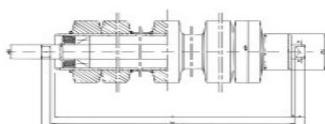



## WZÓR 16 – PROFIL U

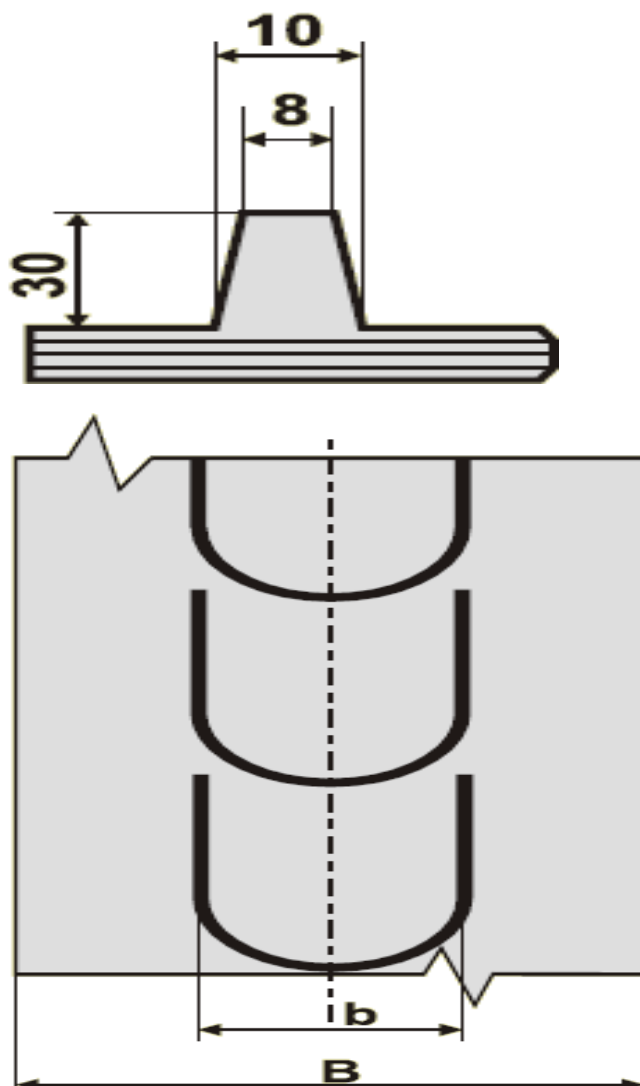

B mm	b mm	t mm
Do uzgodnienia	150	190

Zalecane parametry pracy		
Minimalna średnica bębnow [mm]	Max efektywny kąt pracy	Możliwość pracy w niecce
300	30°	NIE



**Handlex Pol**

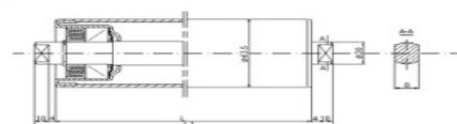
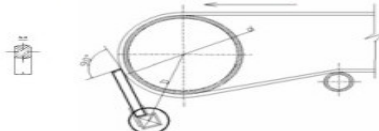
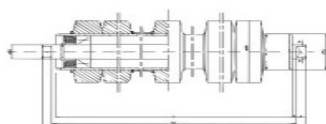



## WZÓR 17 – PROFIL V

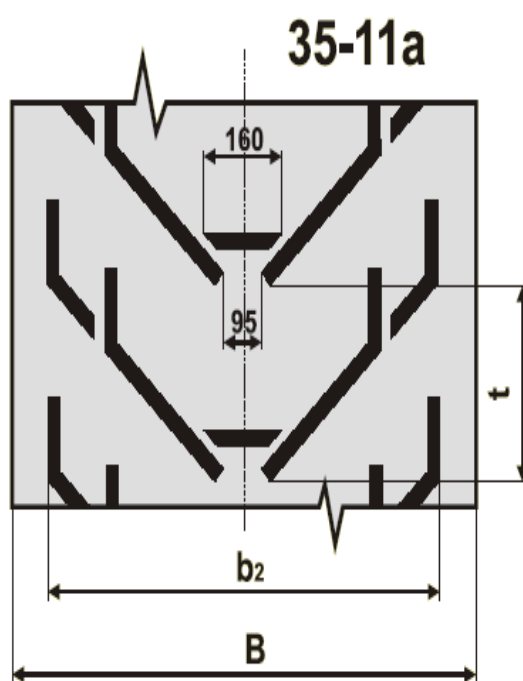
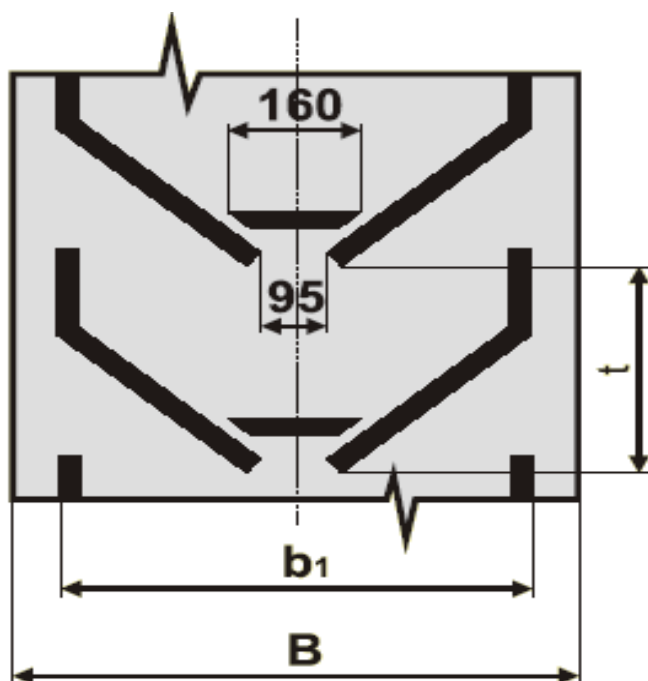
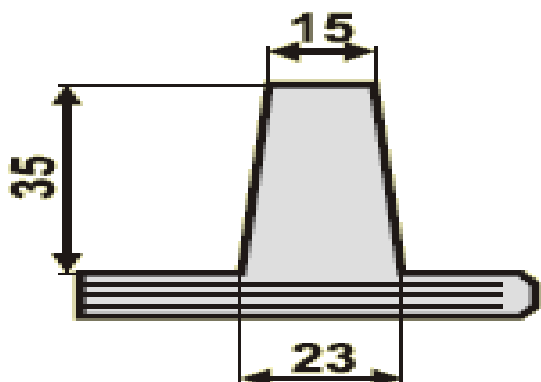

B mm	b <sub>1</sub> mm	b <sub>2</sub> mm	t mm
650 + 800	565		260
1000 + 1200		800	305

Zalecane parametry pracy		
Minimalna średnica bębnow [mm]	Max efektywny kąt pracy	Możliwość pracy w niecce
315	40°	TAK



HandlexPol

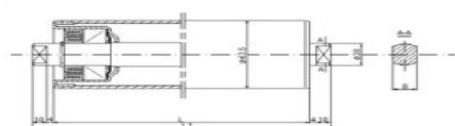
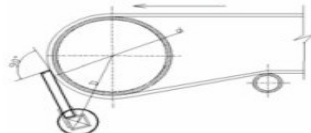
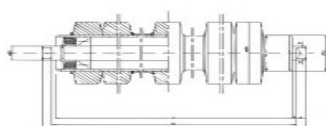

## WZÓR 18 - PROFIL W

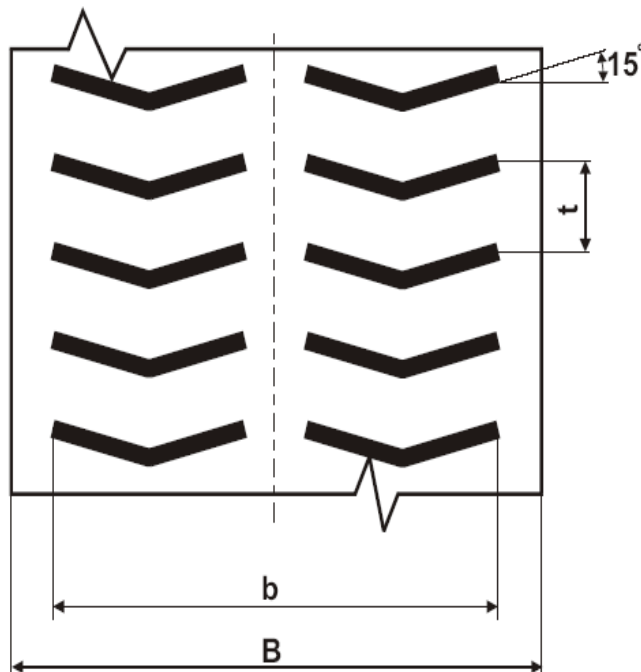
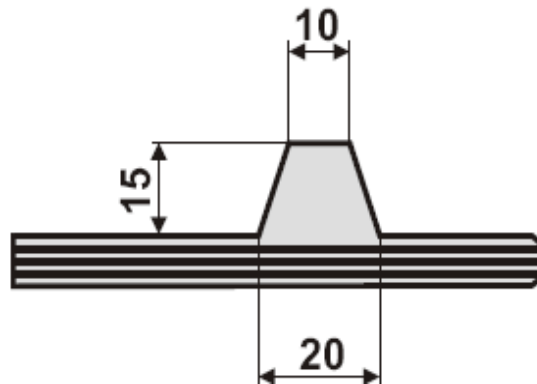

B mm	b mm	t mm
500	435	103

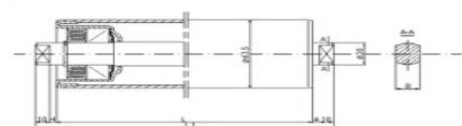
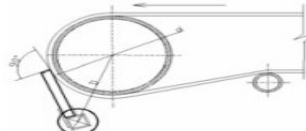
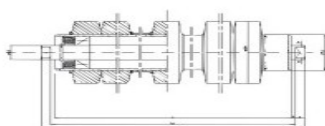

## WZÓR 19 - PROFIL PROSTY

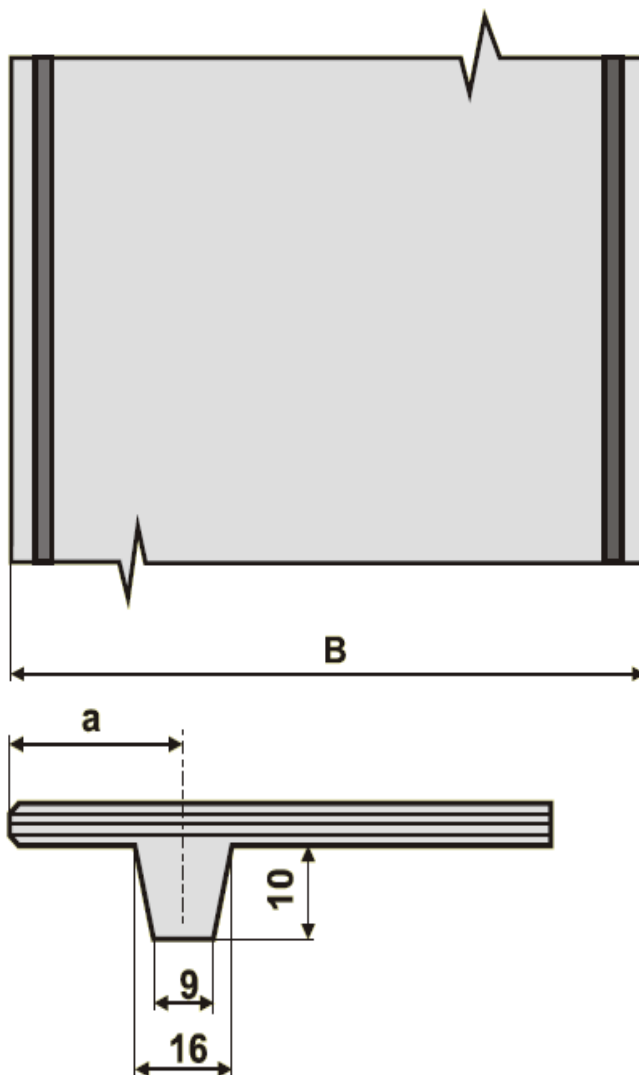

B mm	a mm	t mm
do uzgodnienia	do uzgodnienia	---

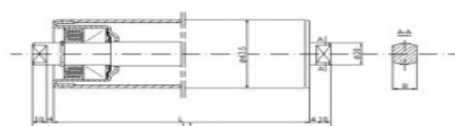
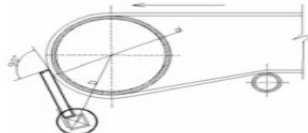
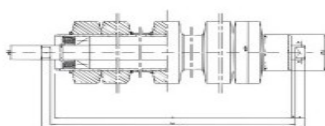
## WZÓR 20 - PROFIL PROSTY

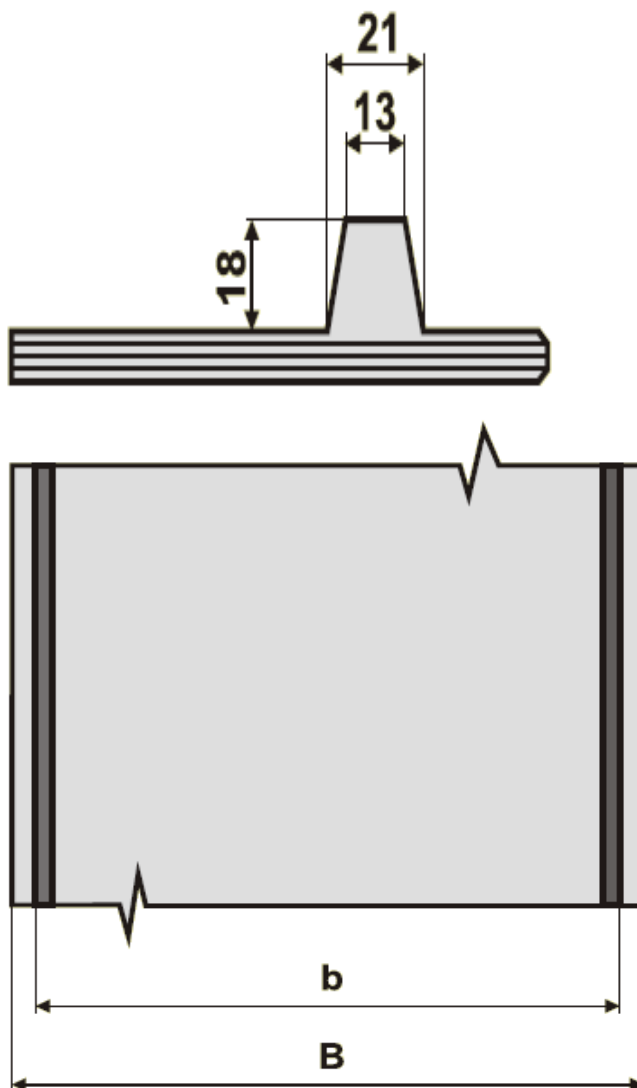

<b>B mm</b>	<b>b mm</b>	<b>t mm</b>
do uzgodnienia	do uzgodnienia	---



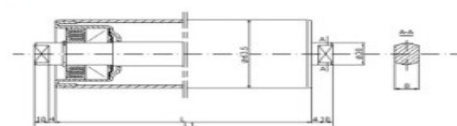
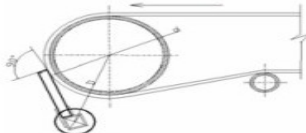
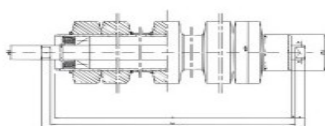

## WZÓR 21 - PROFIL PROSTY

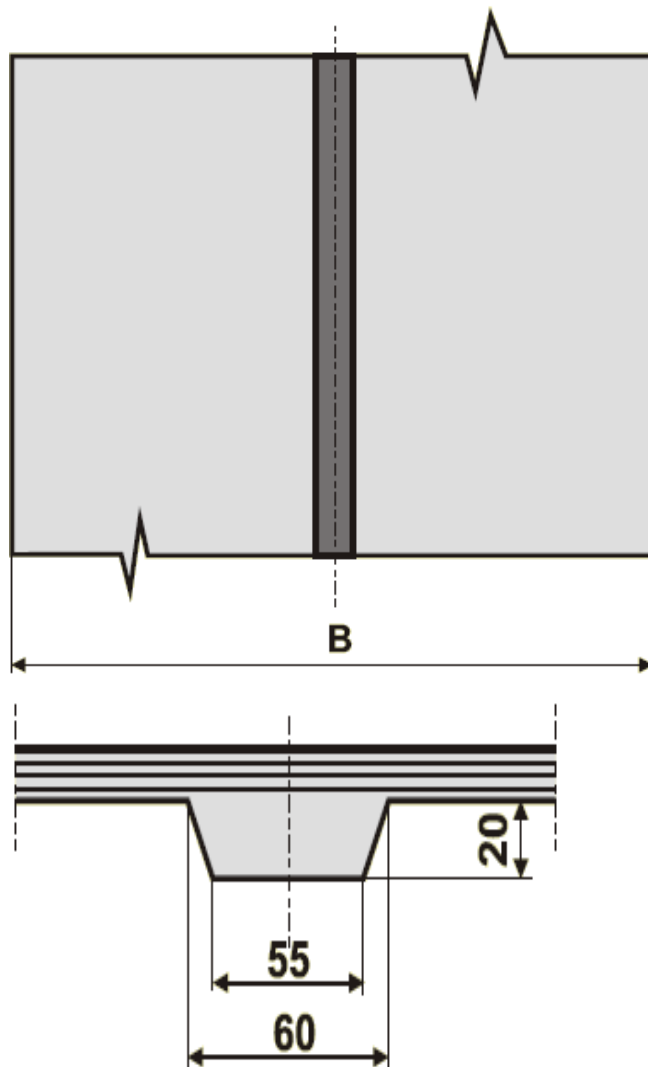

<b>B mm</b>	<b>b mm</b>	<b>t mm</b>
Dowolne	--	--

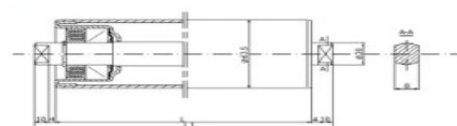
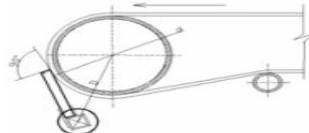
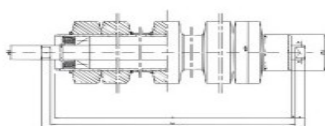

## WZÓR 22 - PROFIL PROSTY

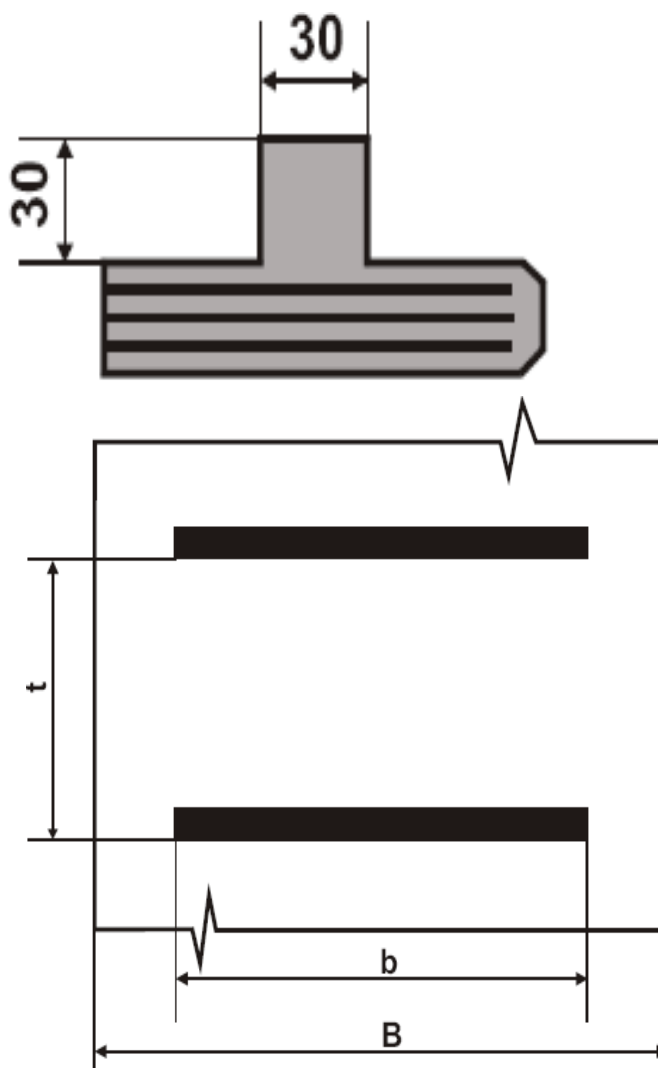

<b>B mm</b>	<b>b mm</b>	<b>t mm</b>
500 + 800	500	do uzgodnienia



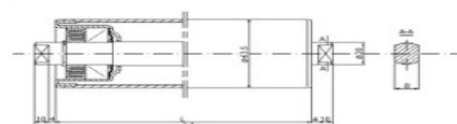
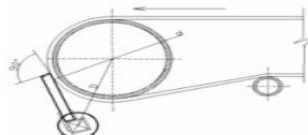
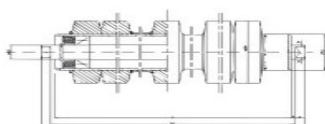

## WZÓR 23 - PROFIL PROSTY

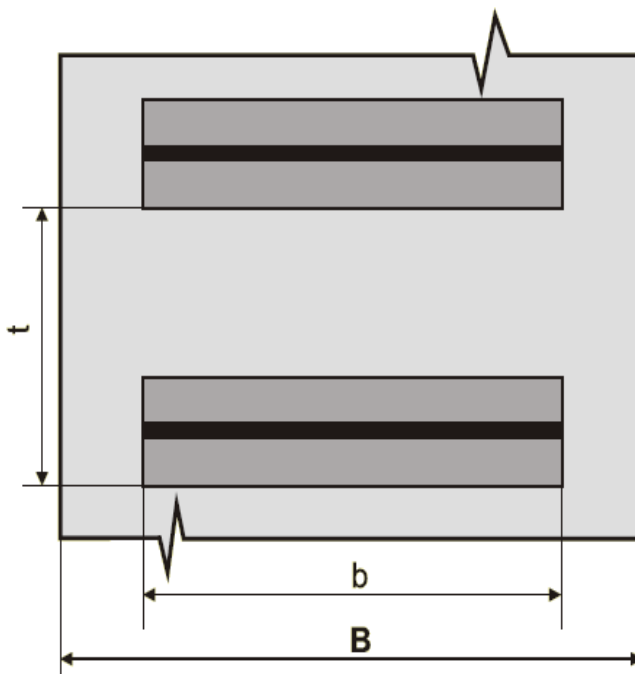
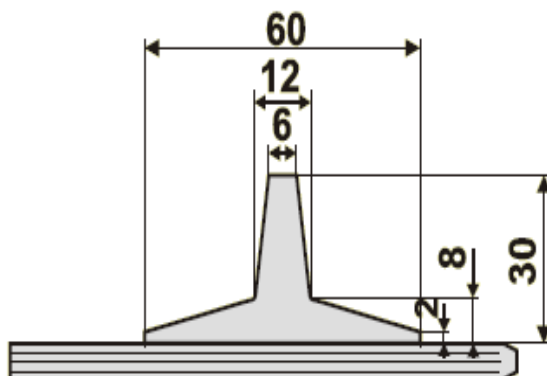

<b>B mm</b>	<b>b mm</b>	<b>t mm</b>
400 ÷ 1000	400 450 500	do uzgodnienia



**HandlexPol**

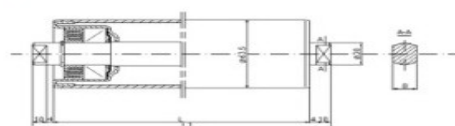
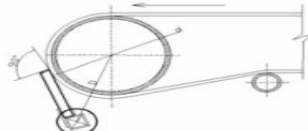
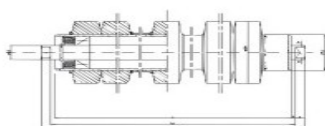

## WZÓR 24 - PROFIL PROSTY

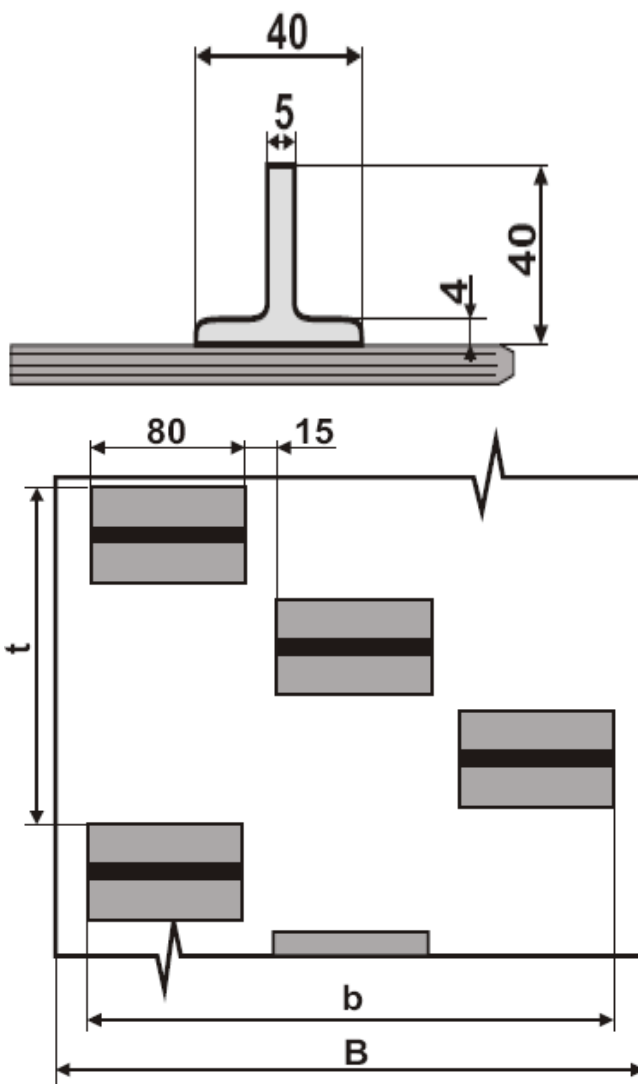

<b>B mm</b>	<b>b mm</b>	<b>t mm</b>
300 ÷ 650	270	175

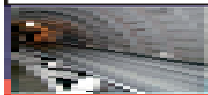

**HandlexPol**

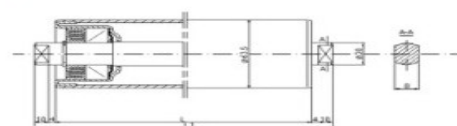
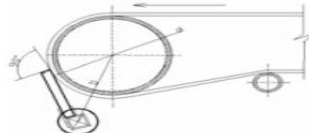
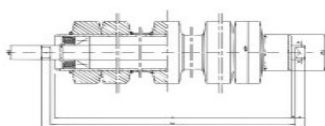



## WZÓR 25 – PROFIL PROSTY

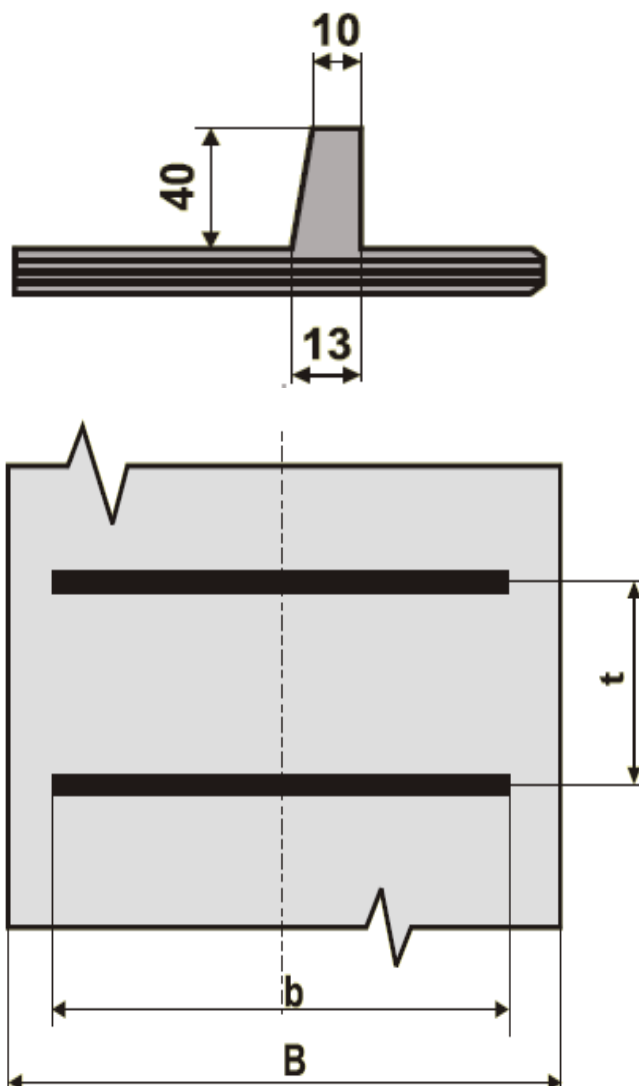

B mm	b mm	t mm
800 + 1000	700	do uzgodnienia

Zalecane parametry pracy		
Minimalna średnica bębnow [mm]	Max efektywny kąt pracy	Możliwość pracy w niecce
250	30°	NIE

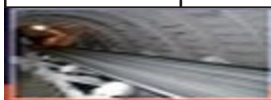

**HandlexPol**

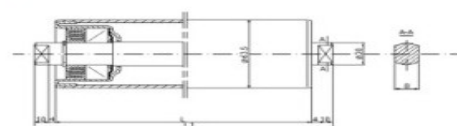
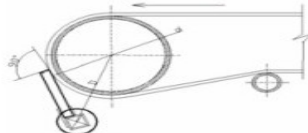
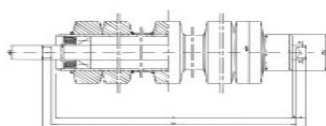

## WZÓR 26 – PROFIL PROSTY

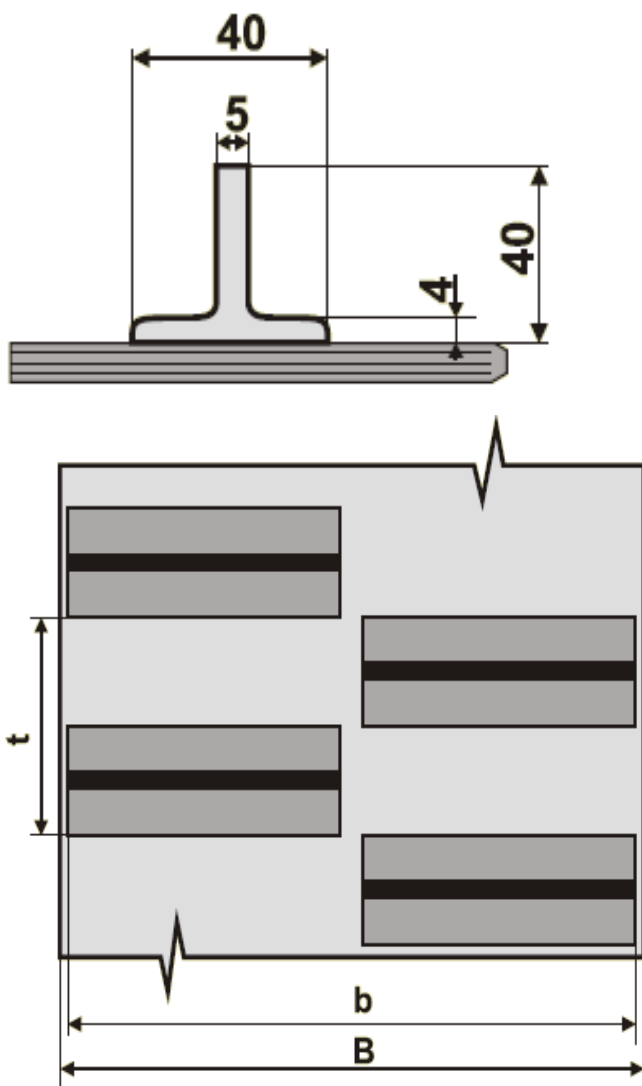

B mm	b mm	t mm	Zalecane parametry pracy		
300 + 650	290	100	Minimalna średnica bębnow [mm]	Max efektywny kąt pracy	Możliwość pracy w nieście
			250	40°	TAK



**HandlexPol**

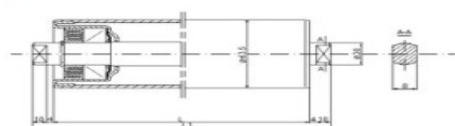
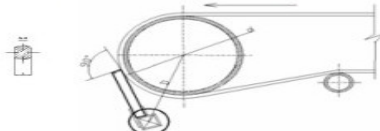
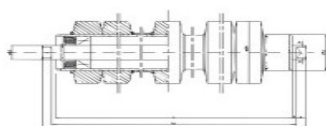

## WZÓR 27 – PROFIL PROSTY POPRZECZNY

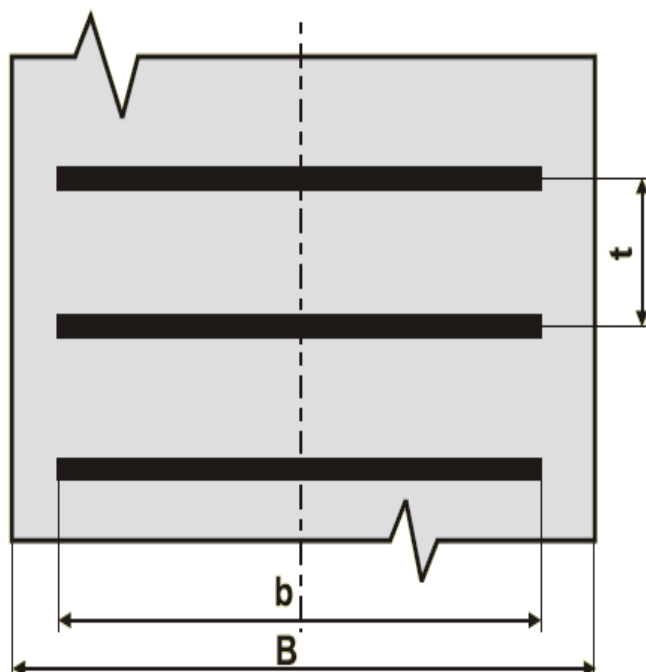
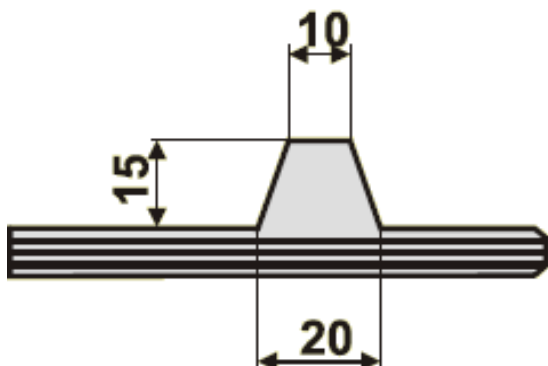

B mm	b mm	t mm
Do uzgodnienia	150	190

Zalecane parametry pracy		
Minimalna średnica bębnow [mm]	Max efektywny kąt pracy	Możliwość pracy w nlece
300	30°	NIE



**HandlexPol**

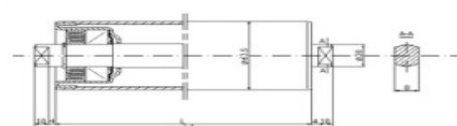
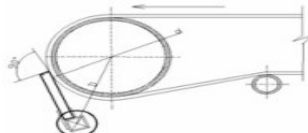
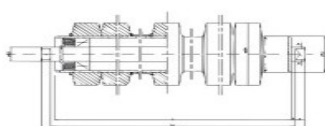

## WZÓR 28 - PROFIL PROSTY POPRZECZNY Z LISTWAMI BOCZNYMI

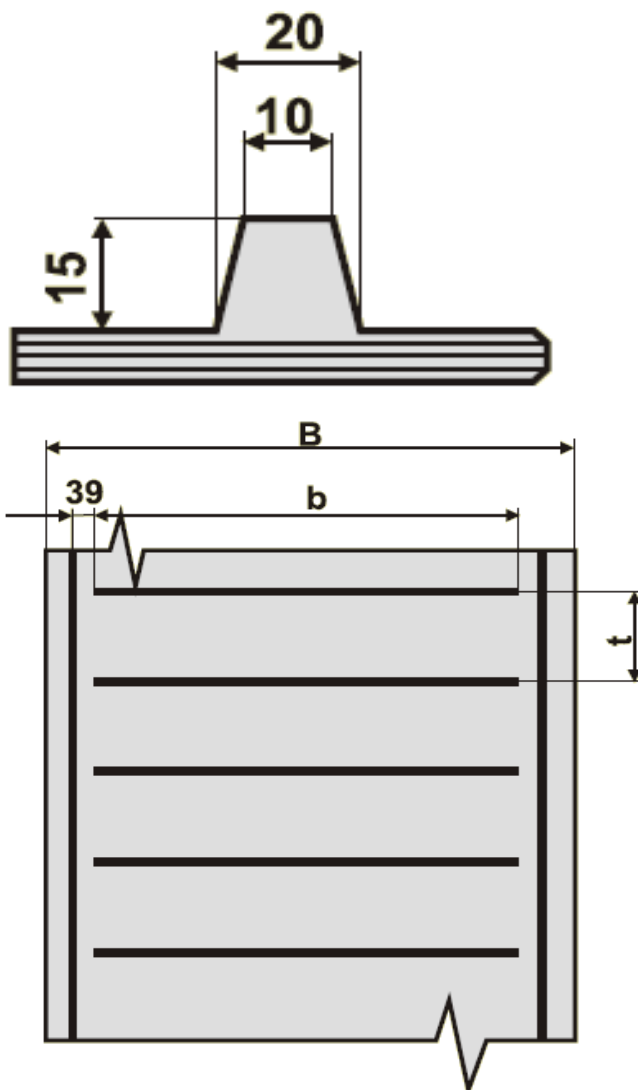

B mm	b mm	t mm
300	290	103
1200	1198	300
1400	1198	300

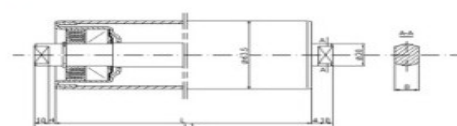
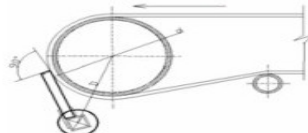
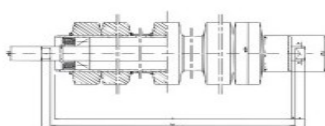



## WZÓR 29 - PROFIL PROSTY DWUDZIELNY

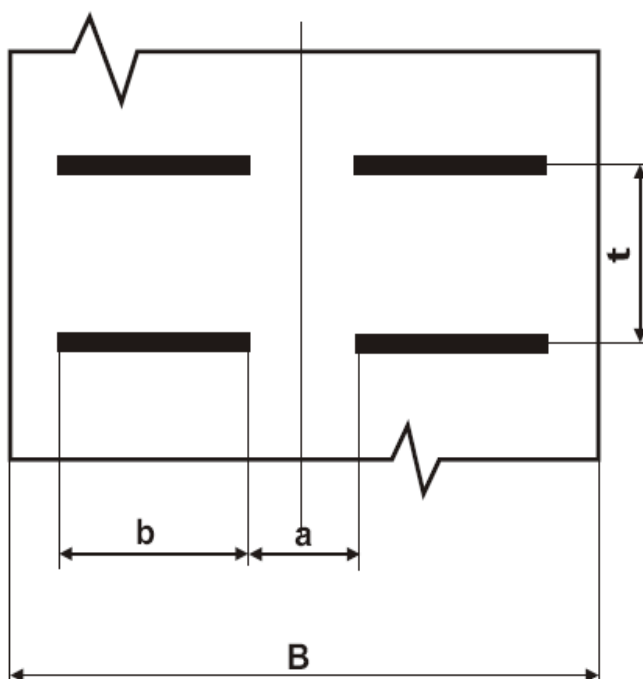
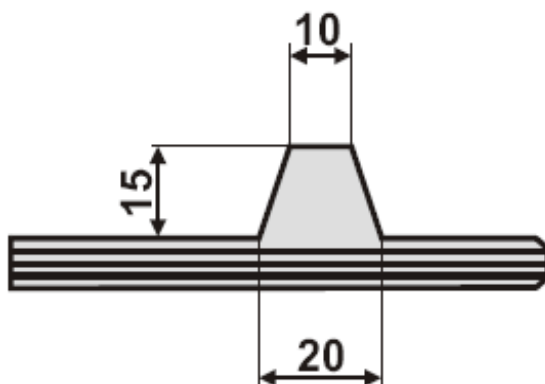

<b>B mm</b>	<b>b mm</b>	<b>a mm</b>	<b>t mm</b>
400 + 1000	do uzgodnienia	do uzgodnienia	do uzgodnienia
 			

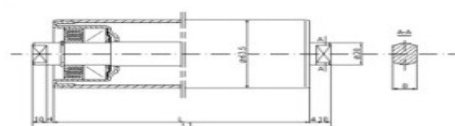
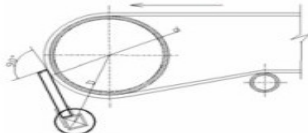
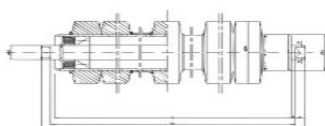

## WZÓR 30 – PROFIL PROSTY DWUDZIELNY

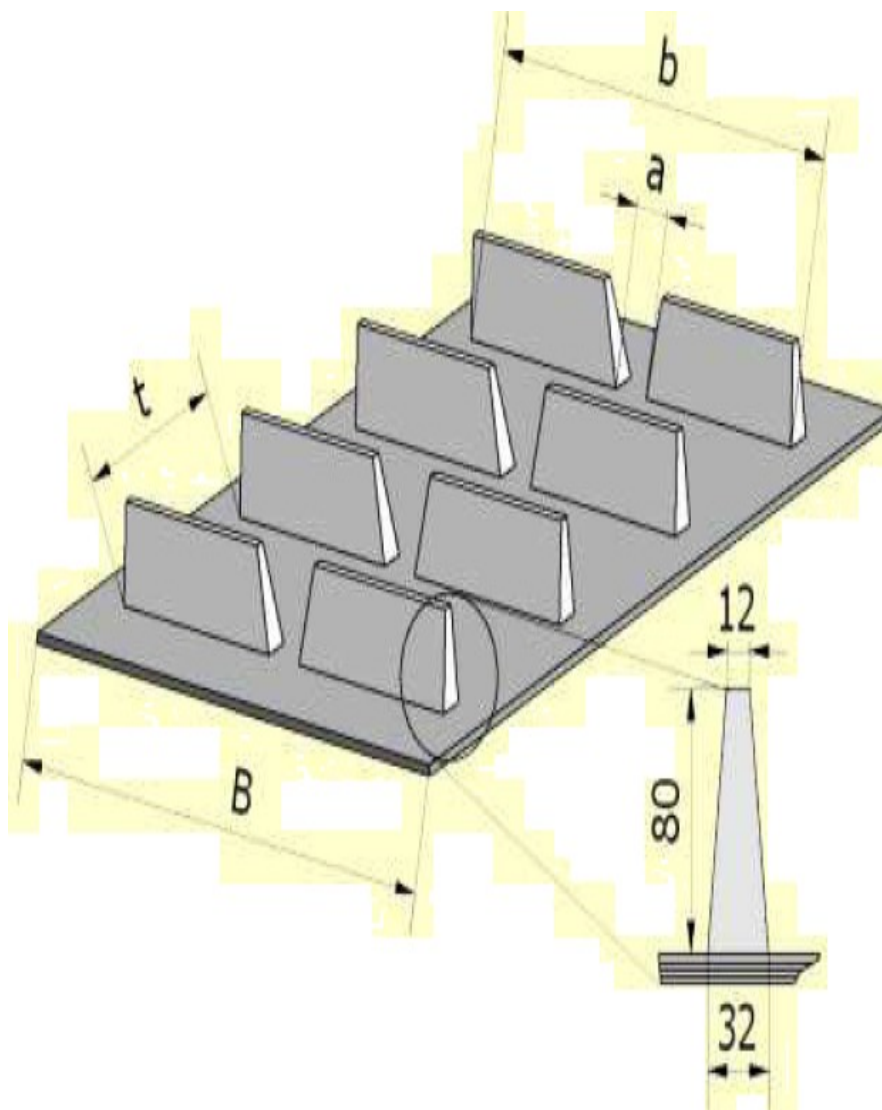

B mm	b mm	a mm	t mm	Zalecane parametry pracy		
600 + 1000	530	50	do uzgodnienia	Minimalna średnica bębnow [mm]	Max efektywny kąt pracy	Możliwość pracy w niecce
				315	40°	TAK



**Handlex**

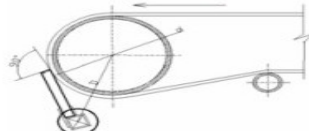
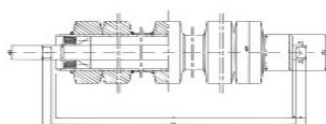

## WZÓR 31 - PROFIL ŚREDNI OTWARTY

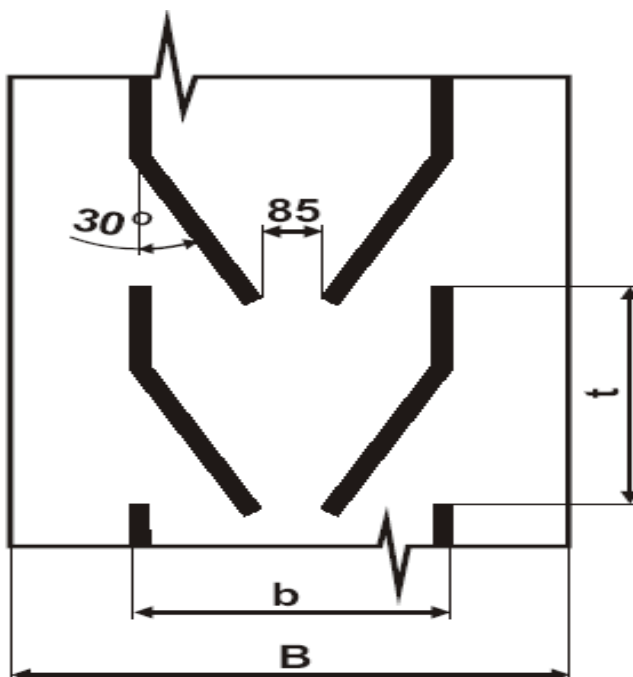
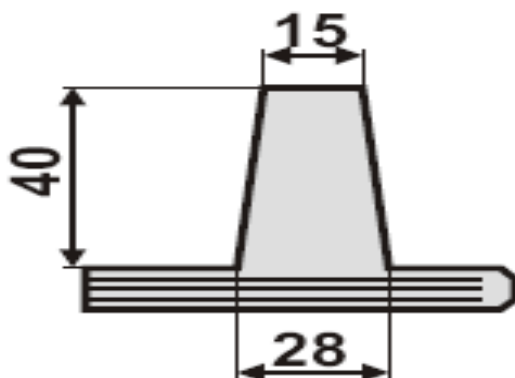

<b>B mm</b>	<b>b mm</b>	<b>t mm</b>
500 ÷ 650	400	320

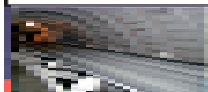

**HandlexPol**

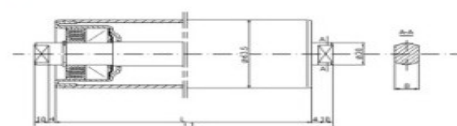
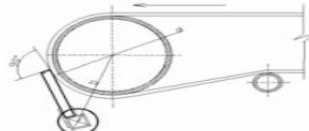
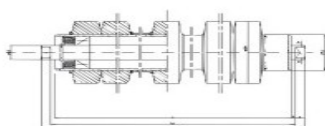

## WZÓR 32 – PROFIL ŚREDNI ZAMKNIĘTY

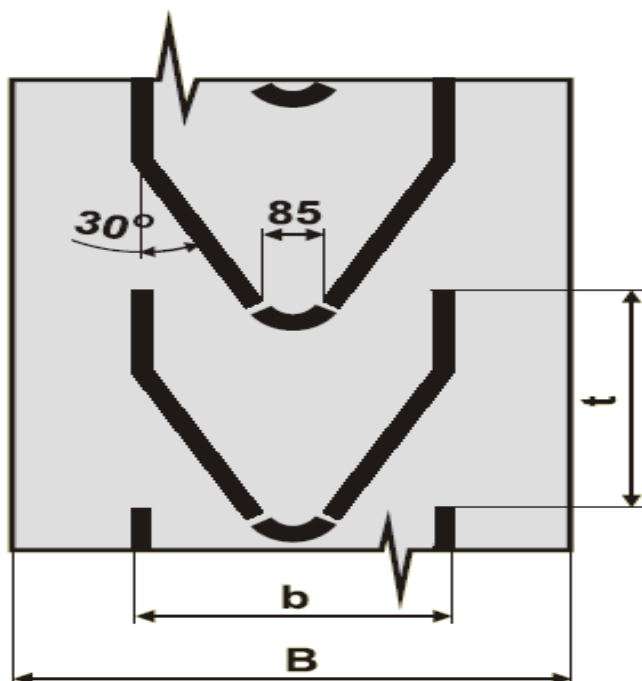
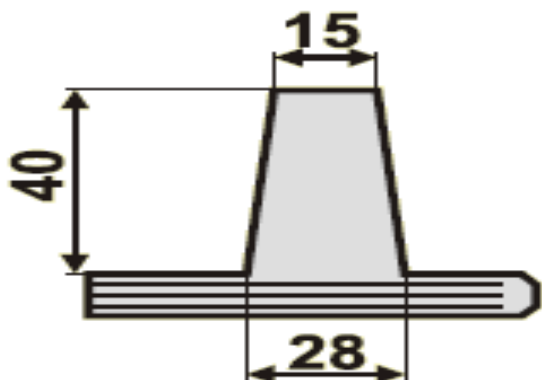

B mm	b mm	t mm
500 + 650	400	320

Zalecane parametry pracy		
Minimalna średnica bębnow [mm]	Max efektywny kąt pracy	Możliwość pracy w niecce
315	40°	TAK

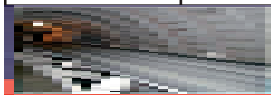

**HandlexPol**

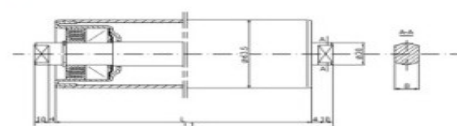
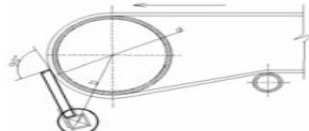
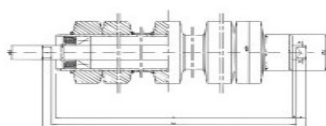



## WZÓR 33 - PROFIL ŚREDNI PODŁUŻNY

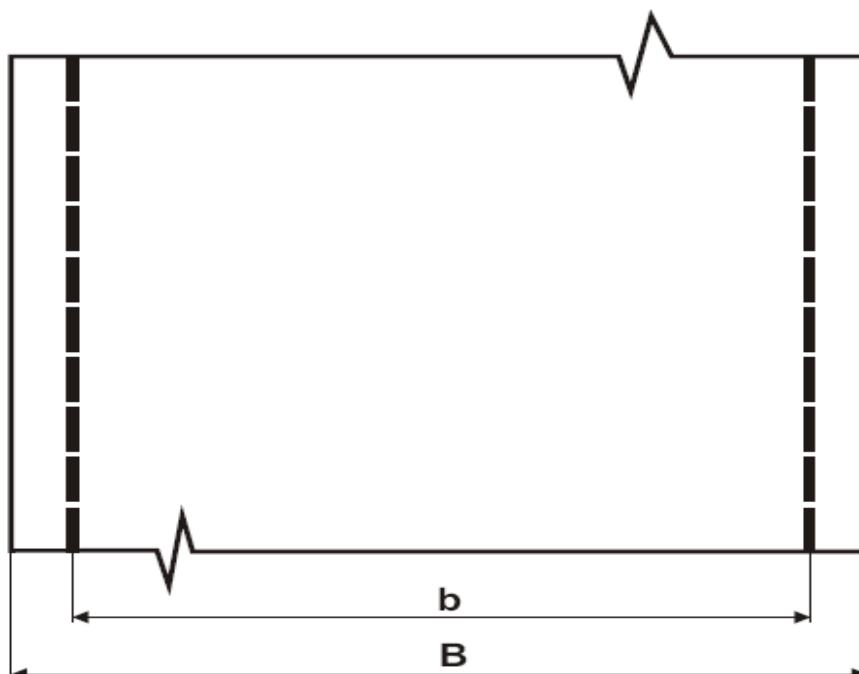
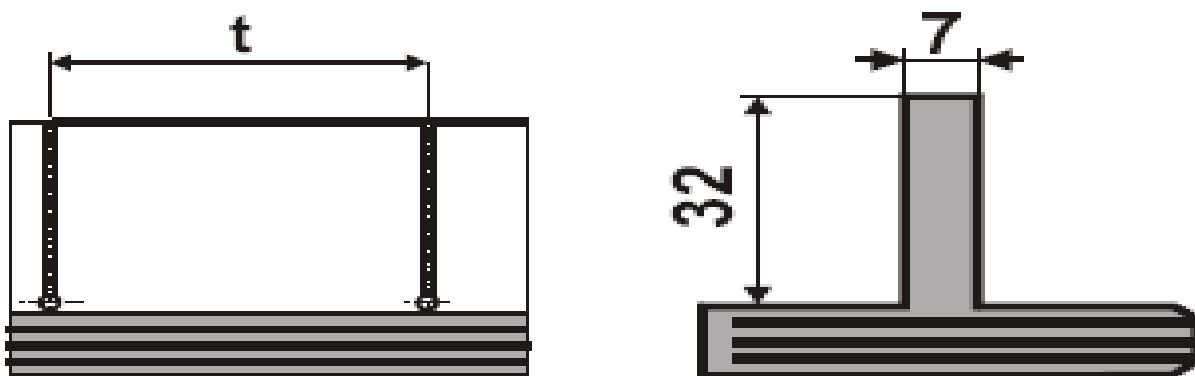

<b>B mm</b>	<b>b mm</b>	<b>t mm</b>
Dowolna	Dowolna	30 do 50



**HandlexPol**

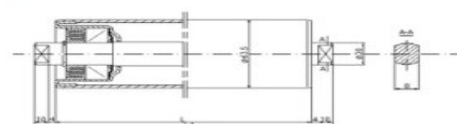
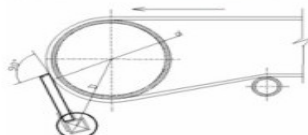
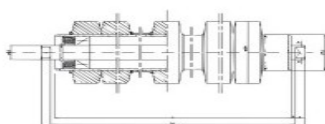

## WZÓR 34 - PROFIL POPRZECZNY

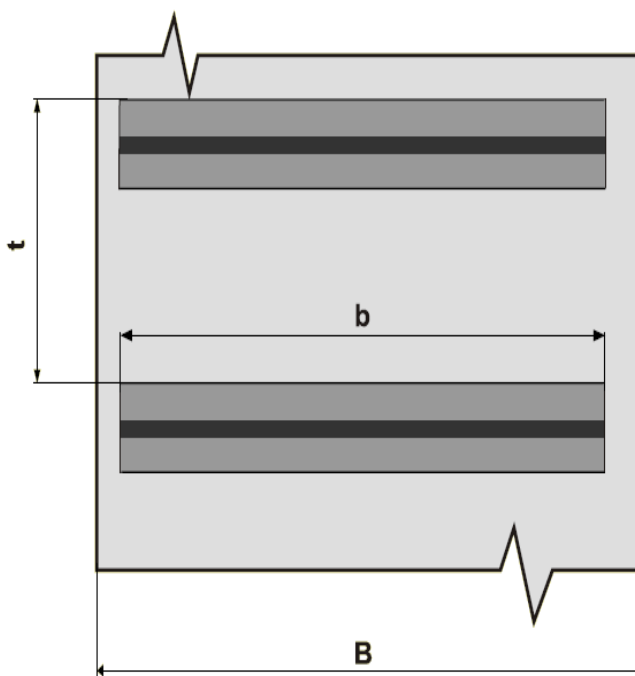
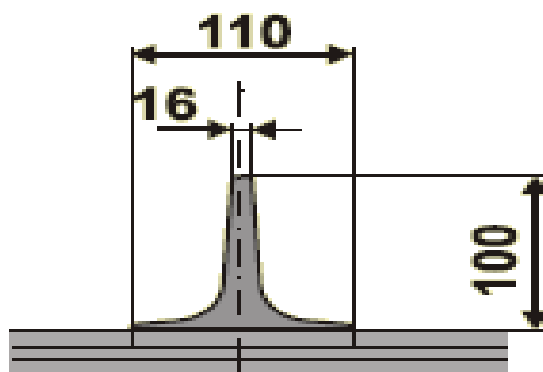

B mm	b mm	t mm
650 800 1000	600	Do uzgodnienia

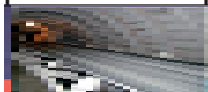

**HandlexPol**

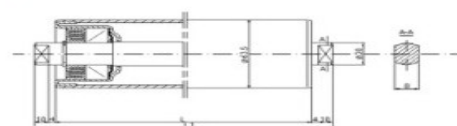
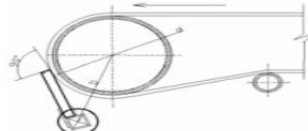
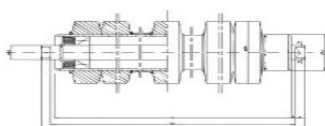

## WZÓR 35 - PROFIL POPRZECZNY WYSOKI DWUDZIELNY

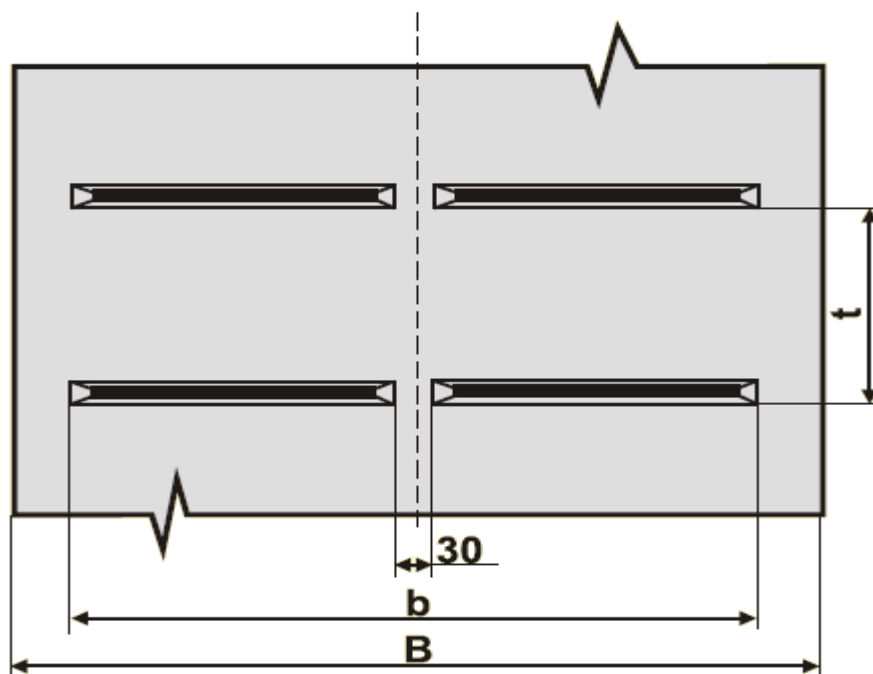
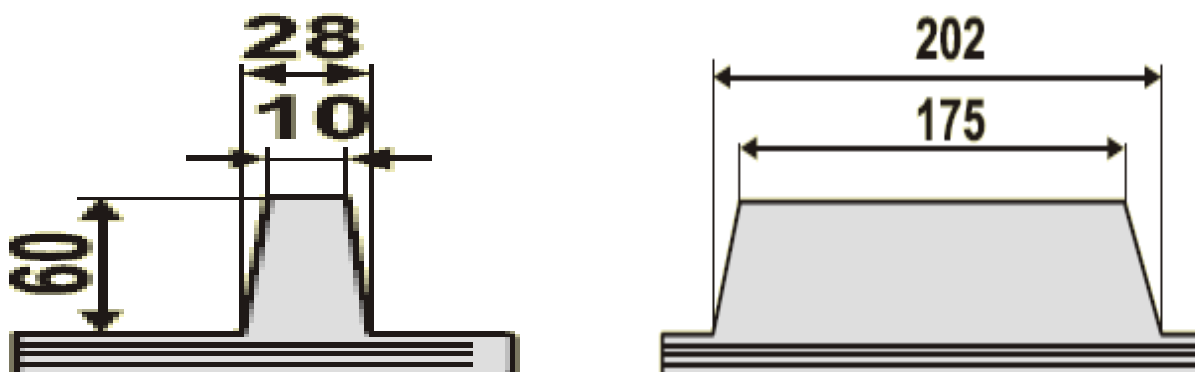

B mm	b mm	t mm
500	434	122
600		
650		

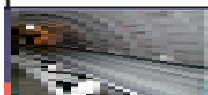

HandlexPol

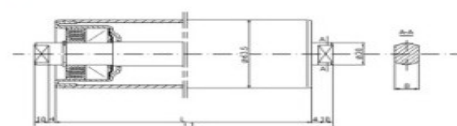
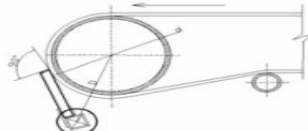
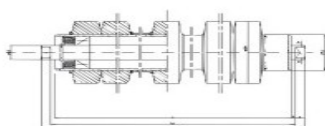

## WZÓR 36 - PROFIL POPRZECZNY WYSOKI DWUDZIELNY

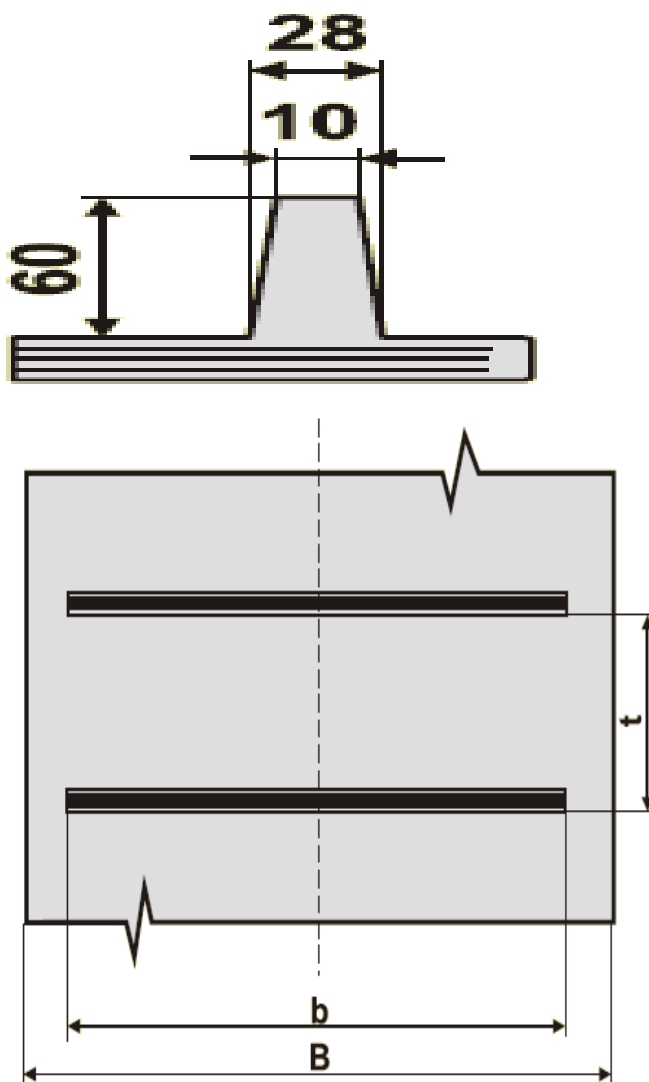

<b>B mm</b>	<b>b mm</b>	<b>t mm</b>
500 600 650	480	dowolne



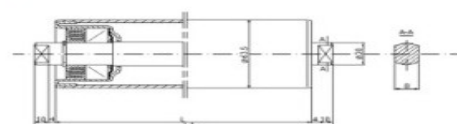
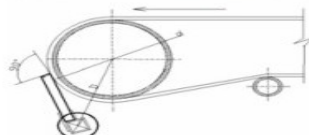
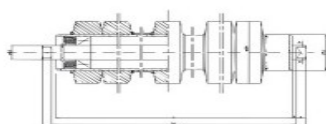



## WZÓR 37 - PROFIL POPRZECZNY WYSOKI DWUDZIELNY

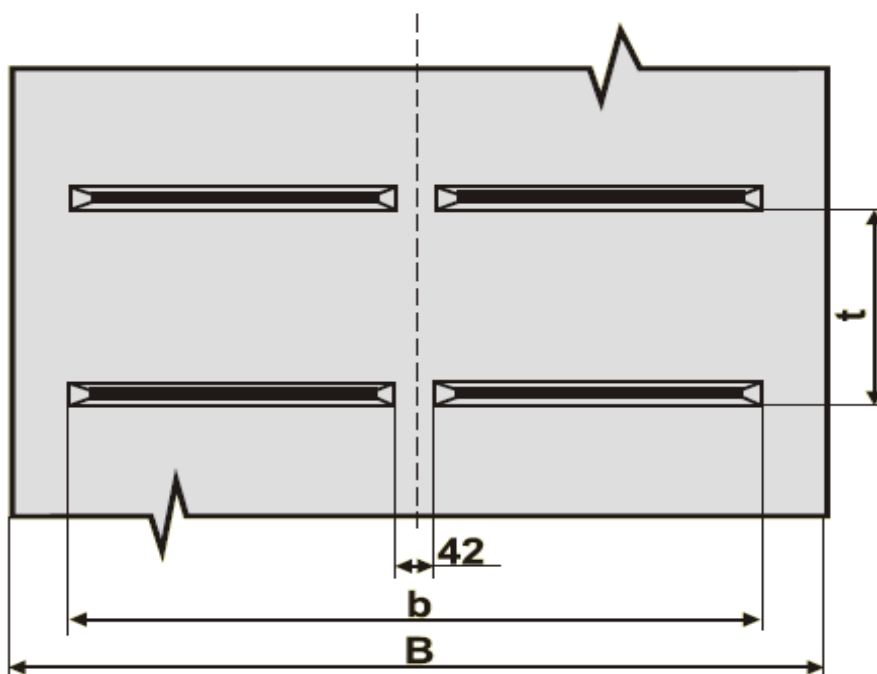
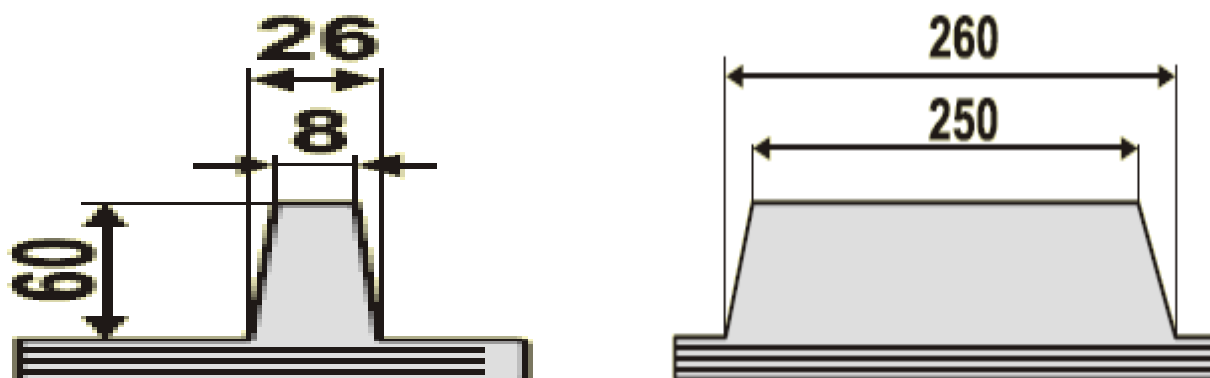

B mm	b mm	t mm
600	562	235
650		
800		

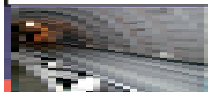

HandlexPol

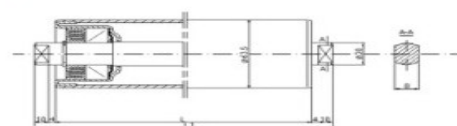
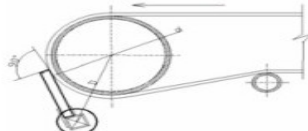
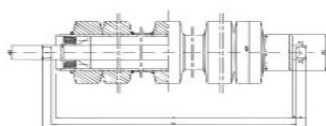

## WZÓR 38 - PROFIL POCHYŁY 65° POPRZECZNY ŚREDNI

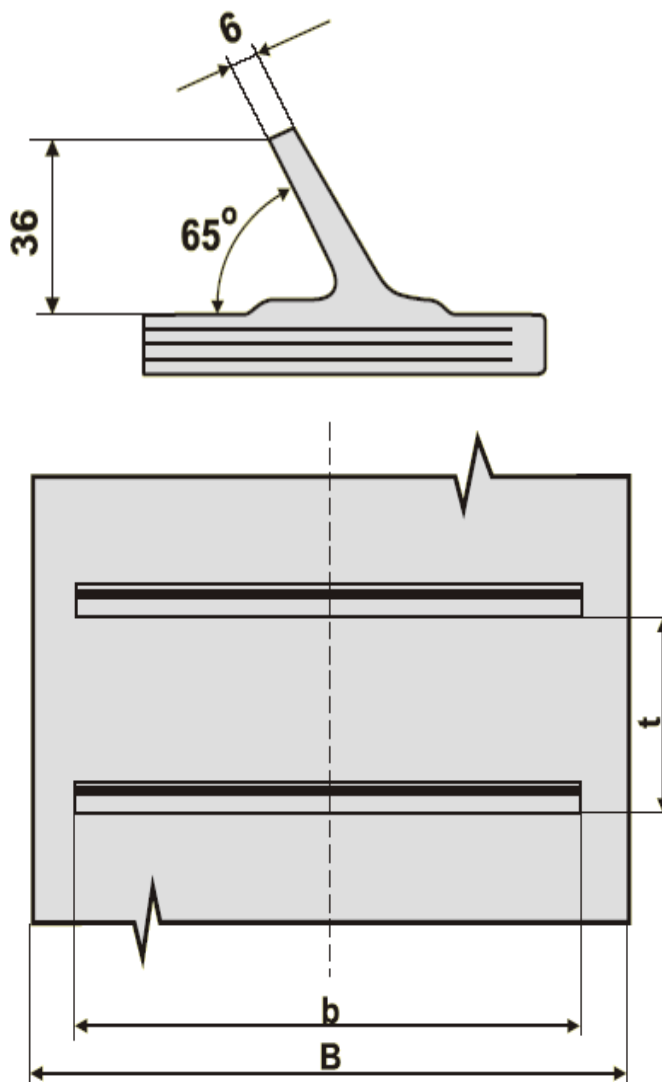

<b>B mm</b>	<b>b mm</b>	<b>t mm</b>
350 + 650	266	115



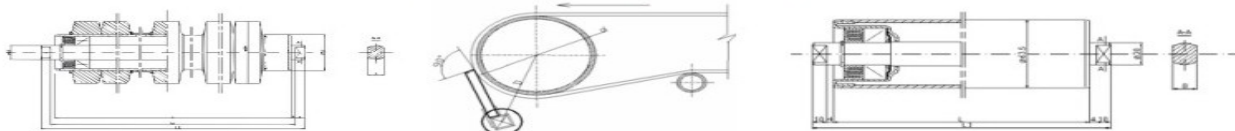

## WZÓR 39 – PROFIL POCHYŁY 65° POPRZECZNY WYSOKI

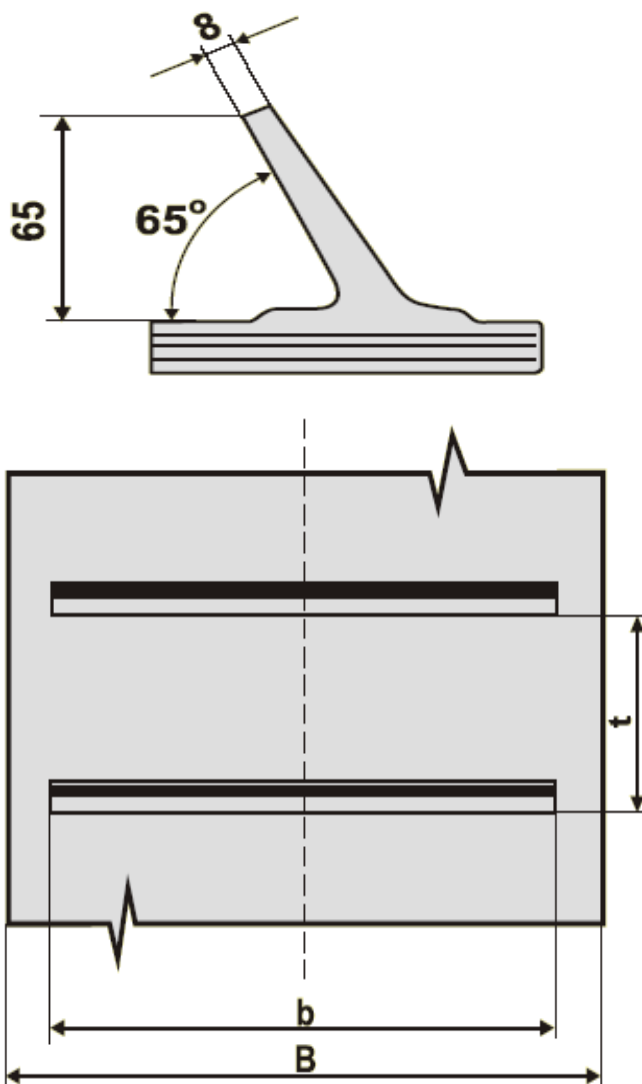

B mm	b mm	t mm
350 + 800	290 370 480 580	dowolne

Zalecane parametry pracy		
Minimalna średnica bębnow [mm]	Max efektywny kąt pracy	Możliwość pracy w niecce
300	40°	NIE



**Handlex**

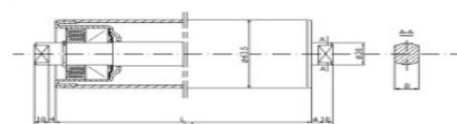
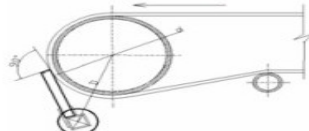
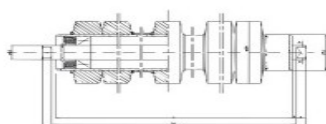

**WZÓR 40 - PROFIL POCHYŁY 65° POPRZECZNY Z LISTWAMI BOCZNYMI**

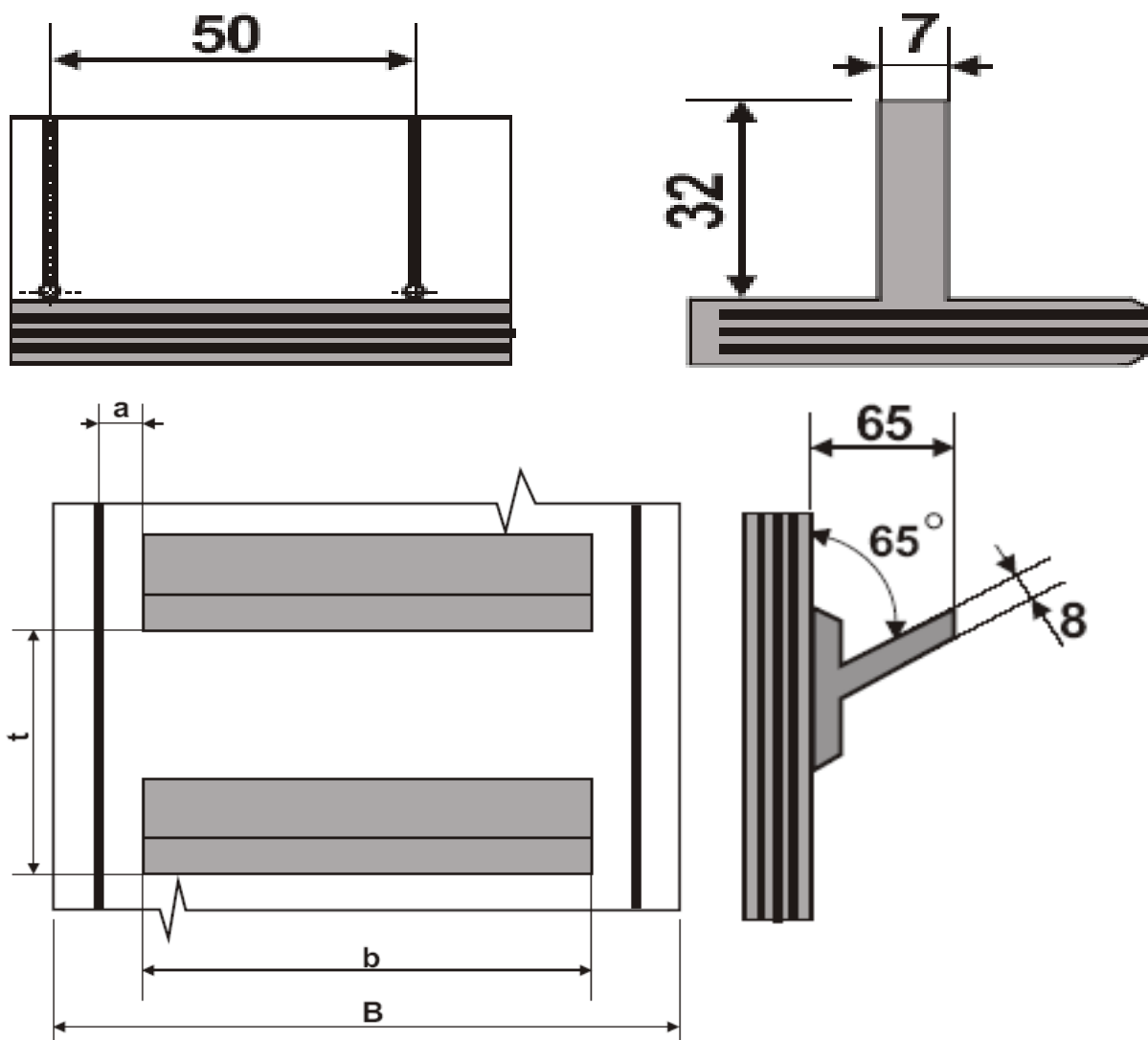

<b>B mm</b>	<b>b mm</b>	<b>t mm</b>
400 + 1000	290, 370, 480, 580, 660, 740	do uzgodnienia

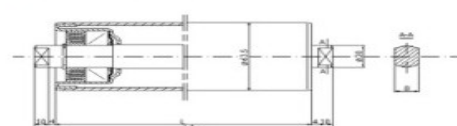
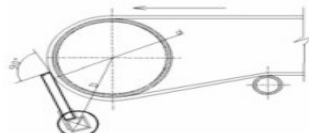
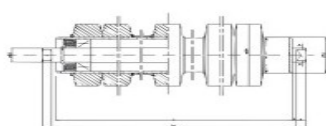



## WZÓR 41 – PROFIL 25 mm POCHYŁY Z LISTWAMI BOCZNYMI

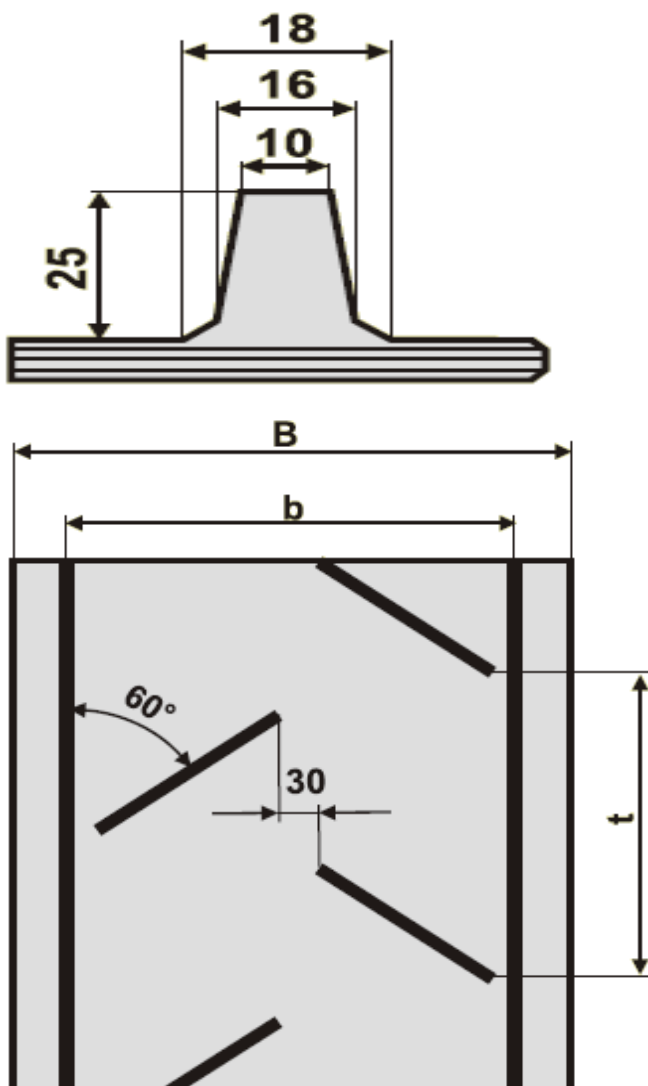

B mm	b mm	t mm
650 + 800	596	500

Zalecane parametry pracy		
Minimalna średnica bębnow [mm]	Max efektywny kąt pracy	Możliwość pracy w niecce
300	30°	TAK

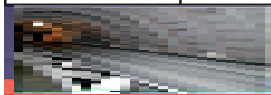

**HandlexPol**

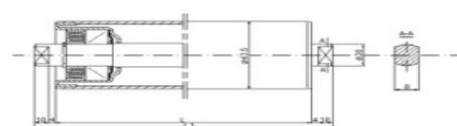
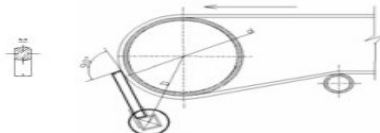
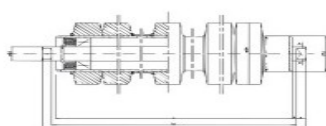

## WZÓR 42 - PROFIL Z FALBANĄ

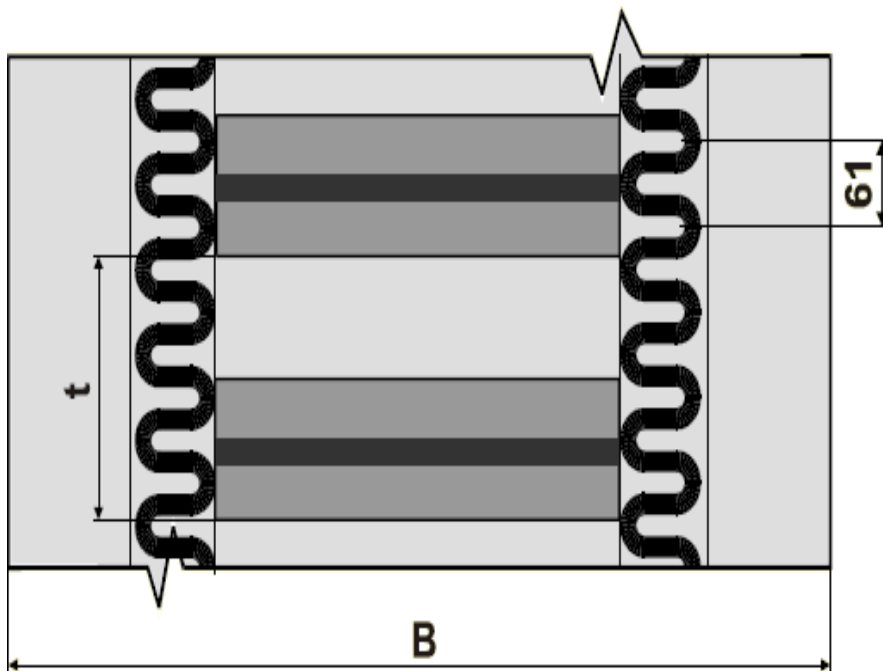
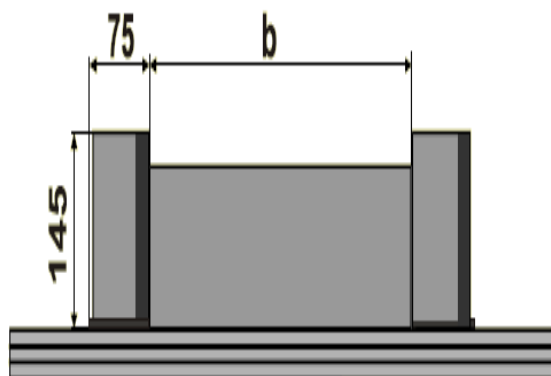
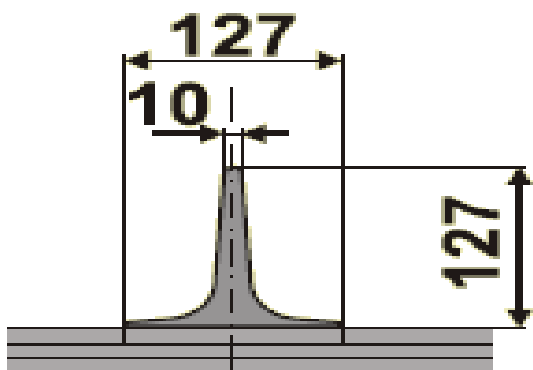

<b>B mm</b>	<b>b mm</b>	<b>t mm</b>
400 + 2000	200 + 1800	200 + 500

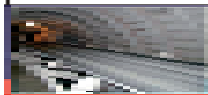

**HandlexPol**

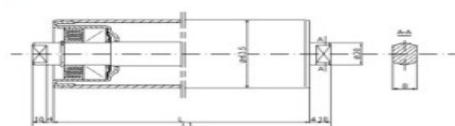
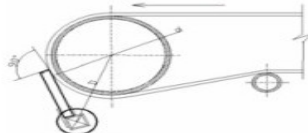
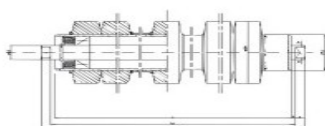

## WZÓR 43 – PROFIL Z FALBANĄ

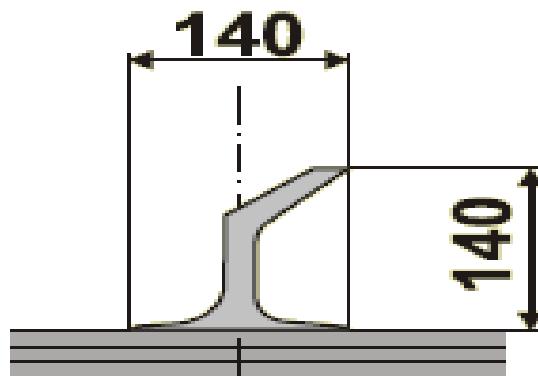
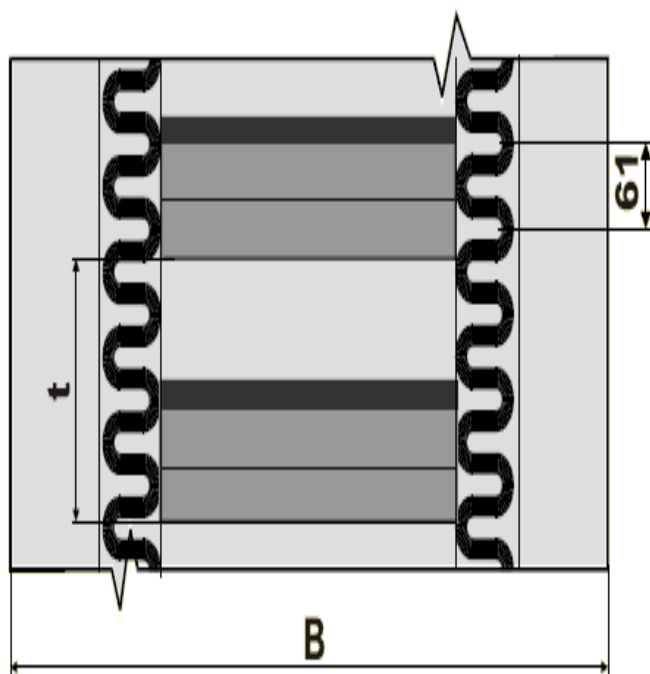
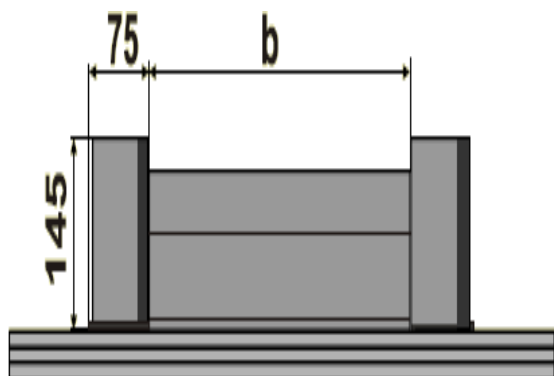

B mm	b mm	t mm
400 + 2000	200 + 1800	200 + 500

Zalecane parametry pracy		
Minimalna średnica bębnow [mm]	Max efektywny kąt pracy	Możliwość pracy w niecce
450	90°	NIE



**HandlexPol**

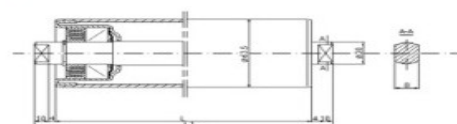
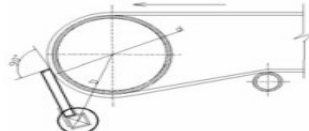
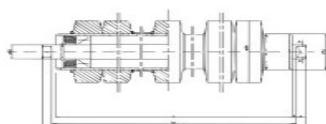

## WZÓR 44 – PROFIL Z FALBANĄ

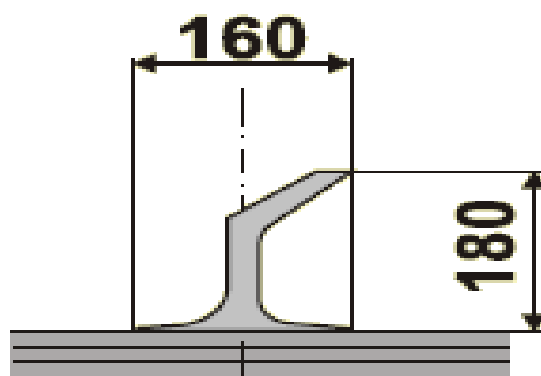
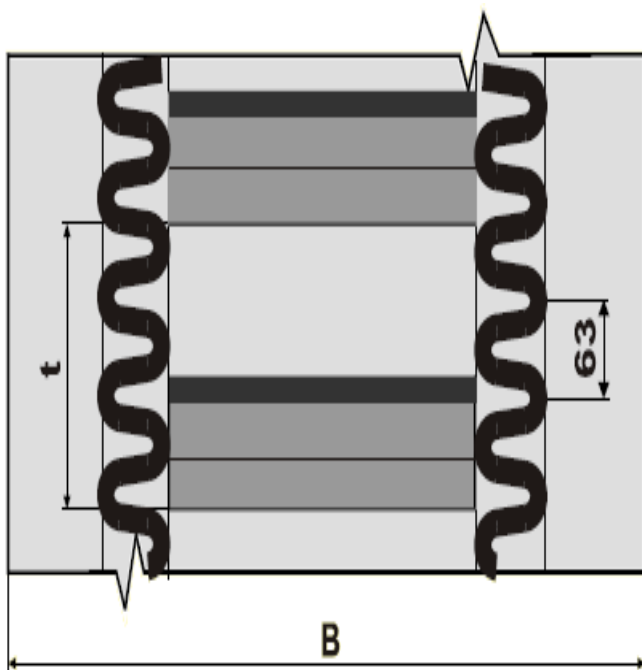
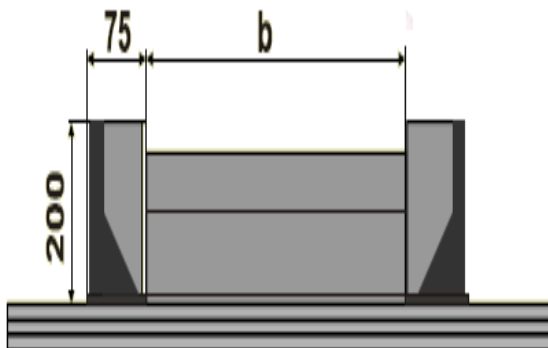

B mm	b mm	t mm
do uzgodnienia	do uzgodnienia	do uzgodnienia

Zalecane parametry pracy		
Minimalna średnica bębnow [mm]	Max efektywny kąt pracy	Możliwość pracy w niecce
800	90°	NIE



**HandlexPol**

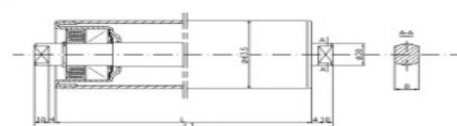
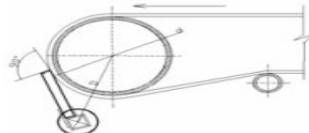
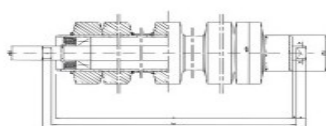



## WZÓR 45 – PROFIL Z FALBANĄ

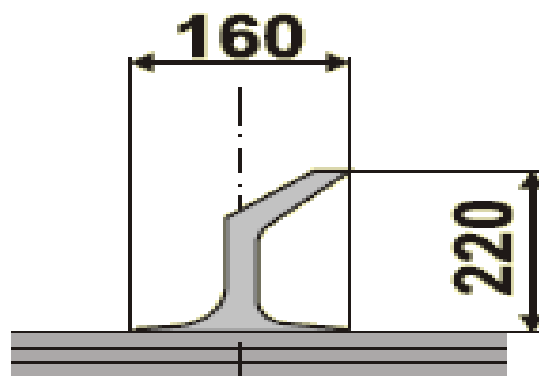
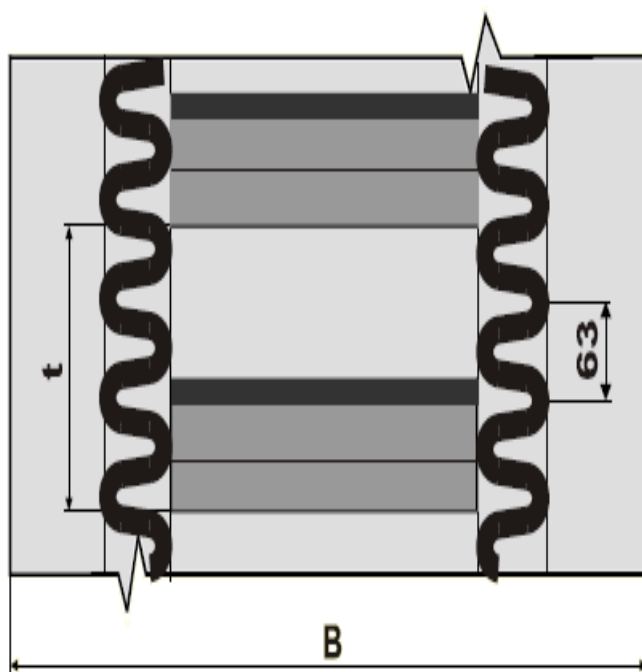
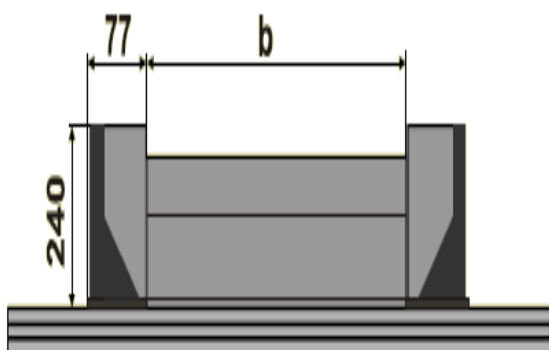

B mm	b mm	t mm
400 + 2000	200 + 1800	200 + 500

Zalecane parametry pracy		
Minimalna średnica bębnow [mm]	Max efektywny kąt pracy	Możliwość pracy w niecce
800	90°	NIE



**HandlexPol**

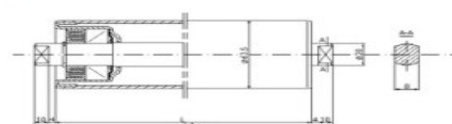
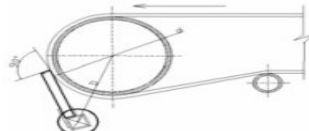
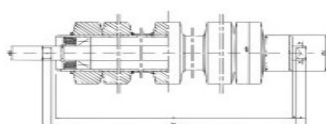

## WZÓR 46 – PROFIL Z FALBANĄ

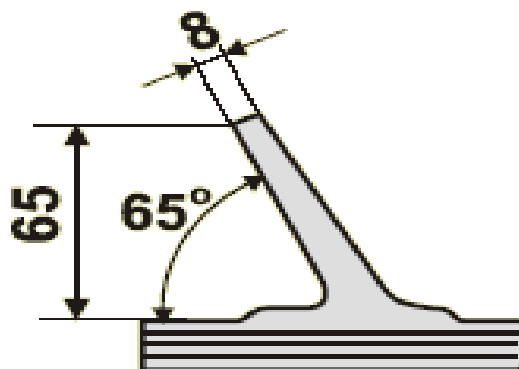
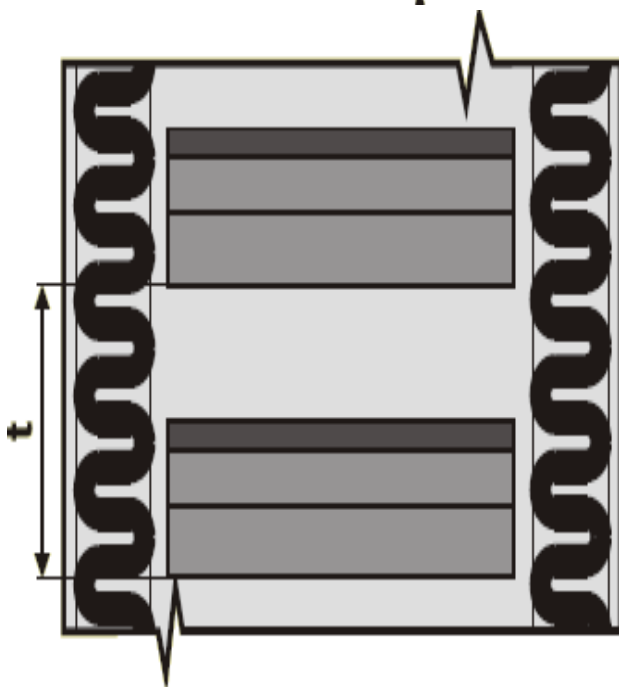
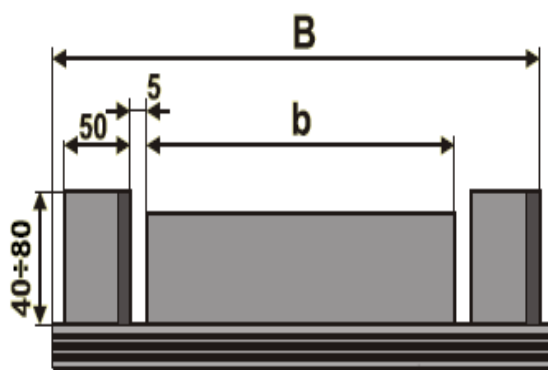

B mm	b mm	t mm	Zalecane parametry pracy		
300 + 2000	80 + 1920	160 + 500	Minimalna średnica bębnow [mm]	Max efektywny kąt pracy	Możliwość pracy w niecce
			400	60°	NIE



**HandlexPol**

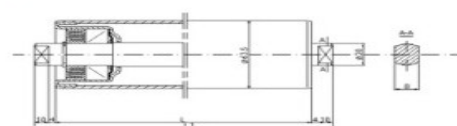
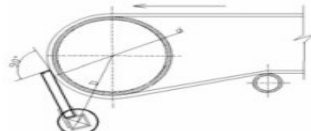
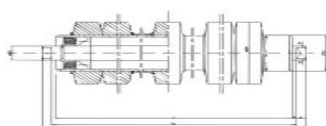

## WZÓR 47 – PROFIL Z FALBANĄ

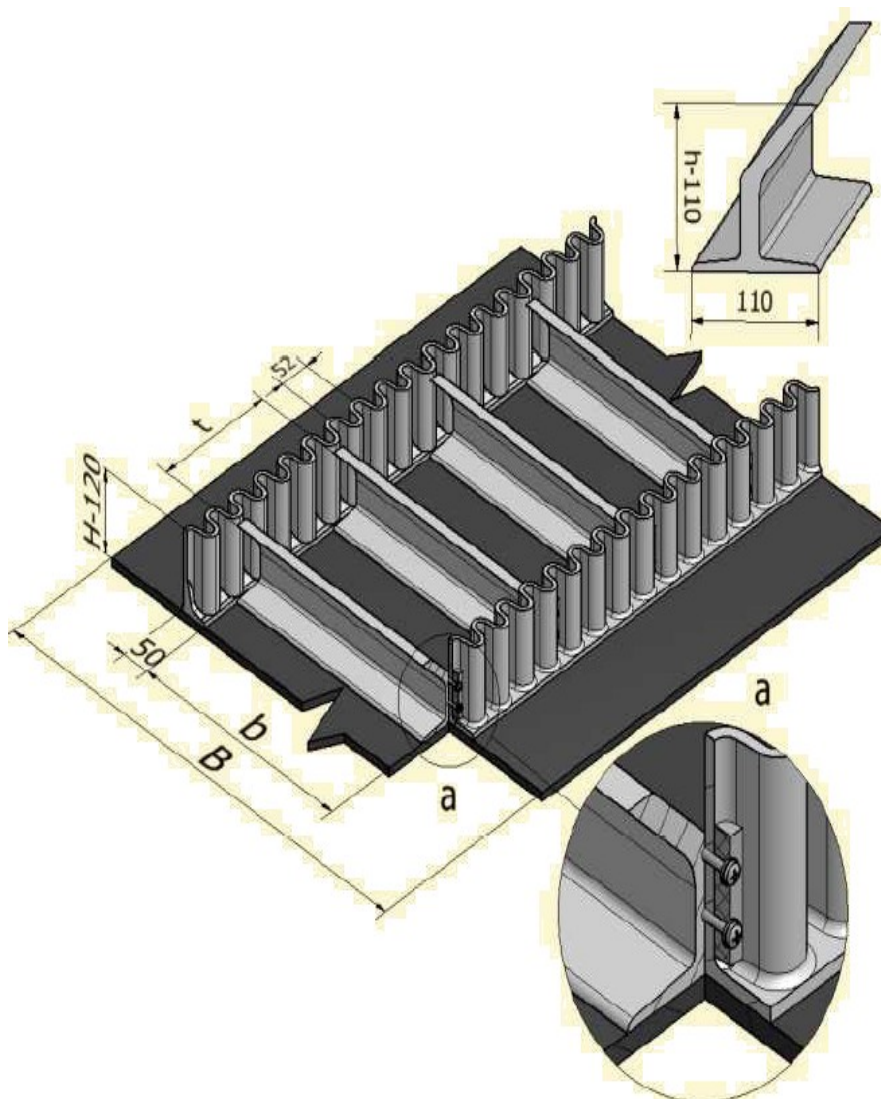

B mm	b mm	t mm	Zalecane parametry pracy		
400	200 + 500	208	Minimalna średnica bębnow [mm]	Max efektywny kąt pracy	Możliwość pracy w niecce
500		260	400	90°	NIE
600		312			
650		364			
800					

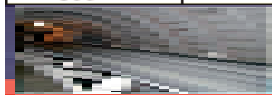

**HandlexPol**

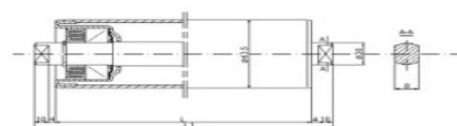
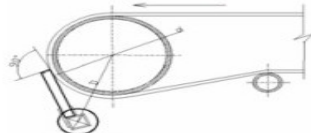
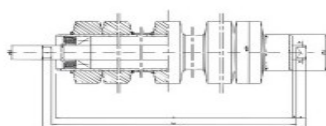



## WZÓR 48 – PROFIL Z FALBANĄ

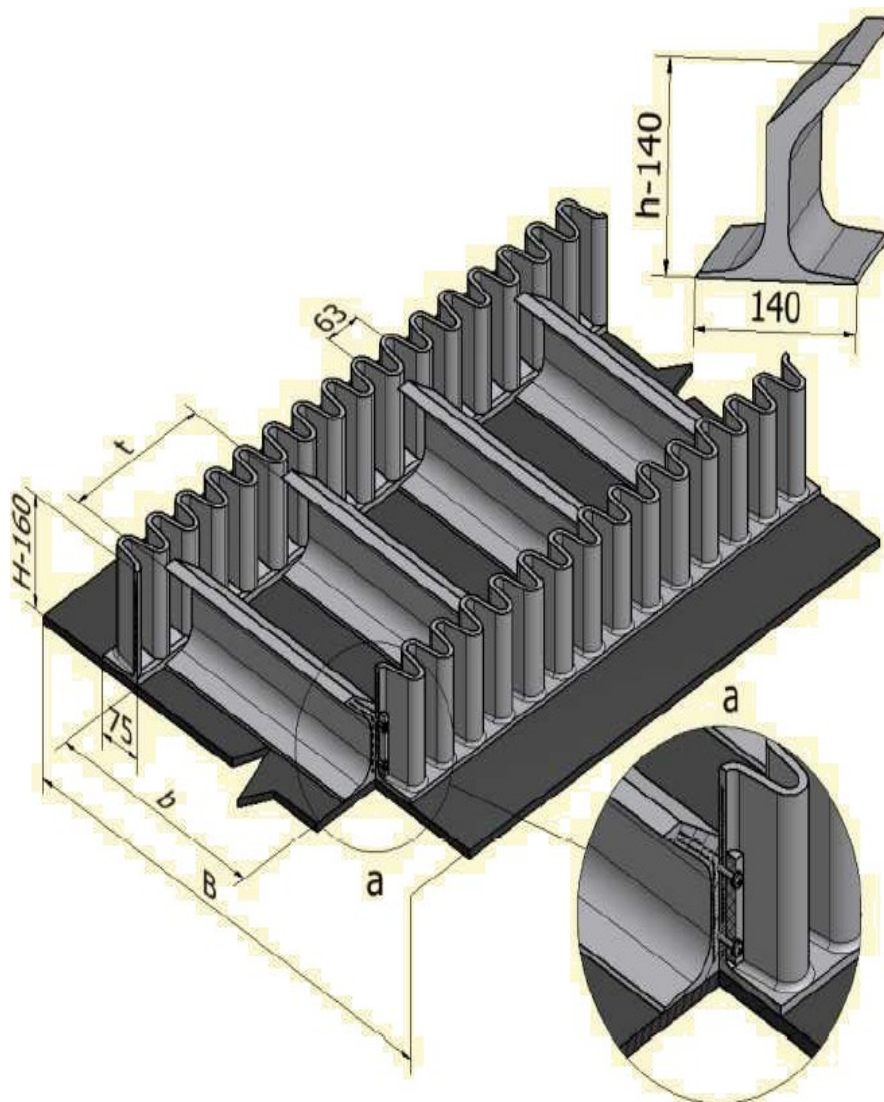

B mm	b mm	t mm	Zalecane parametry pracy		
650	300 + 490	189	Minimalna średnica bębnow [mm]	Max efektywny kąt pracy	Możliwość pracy w niecce
800		252	400	90°	NIE
1000		315			
1200		378			

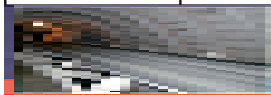

**HandlexPol**

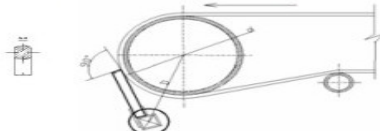
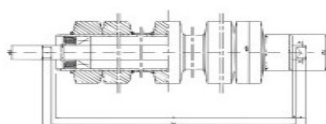



## WZÓR 49 – PROFIL TRÓJDZIELNY

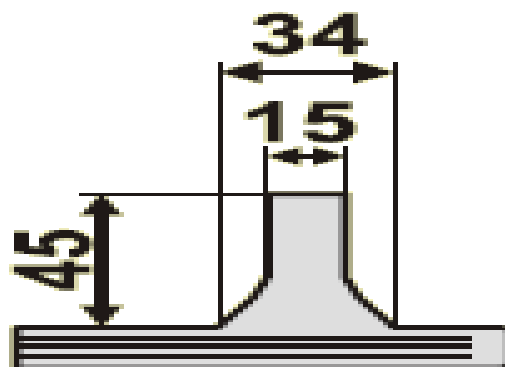
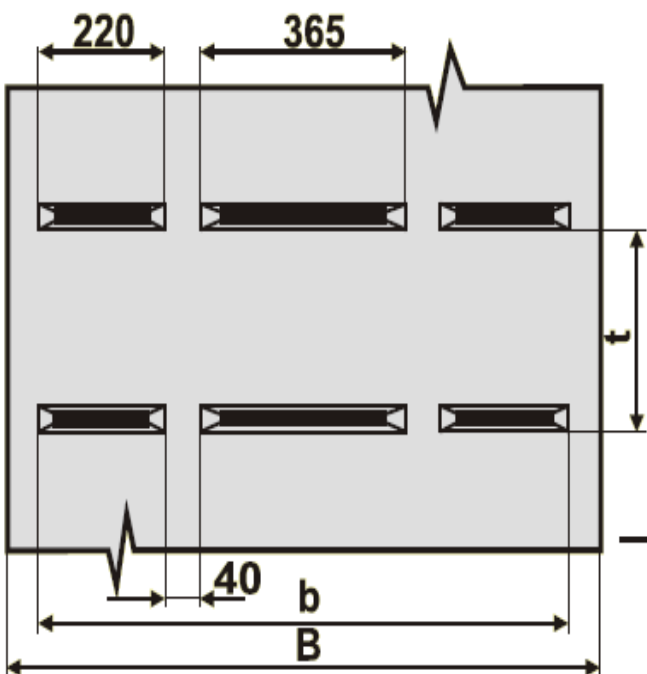
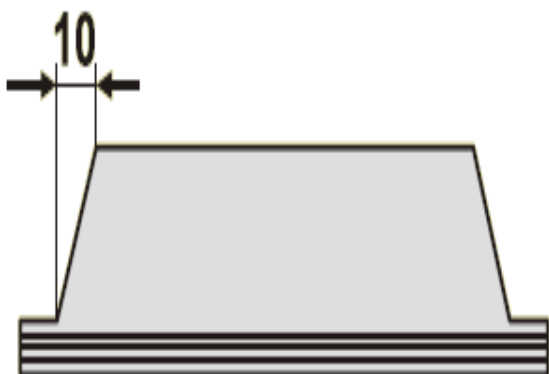

B mm	b mm	t mm	Zalecane parametry pracy		
1000 + 1400	885	do uzgodnienia	Minimalna średnica bębnow [mm]	Max efektywny kąt pracy	Możliwość pracy w niecce
			300	45°	TAK

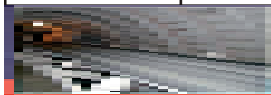

**HandlexPol**

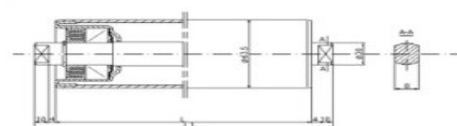
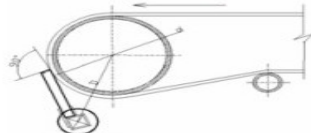
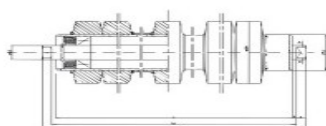

## WZÓR 50 – TAŚMA SPECJALNA

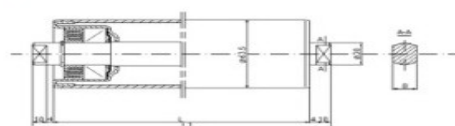
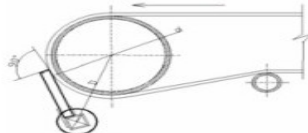
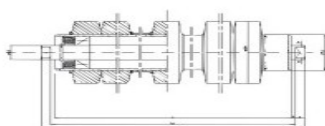
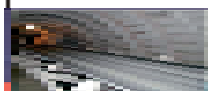
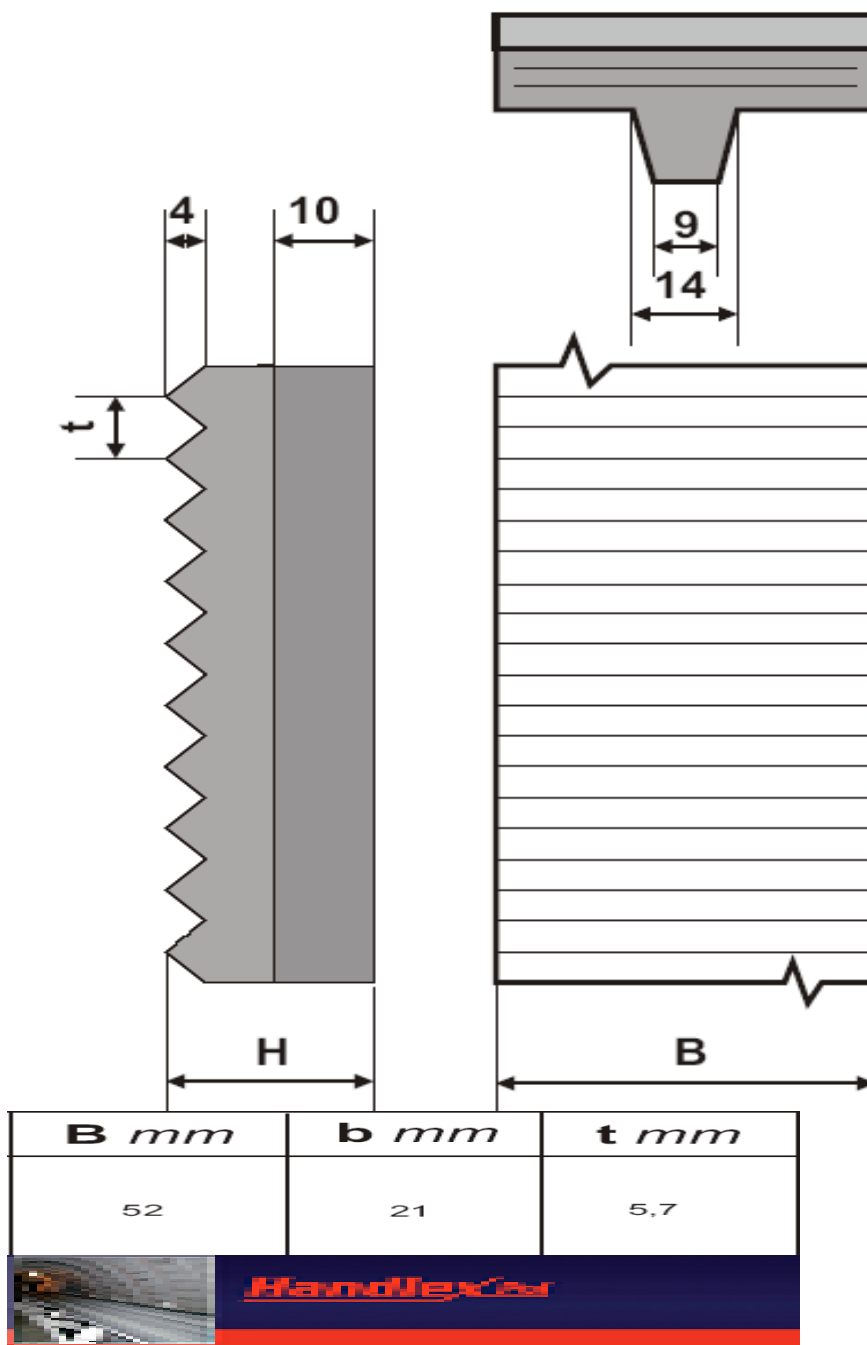

## WZÓR 51 – TAŚMA SPECJALNA

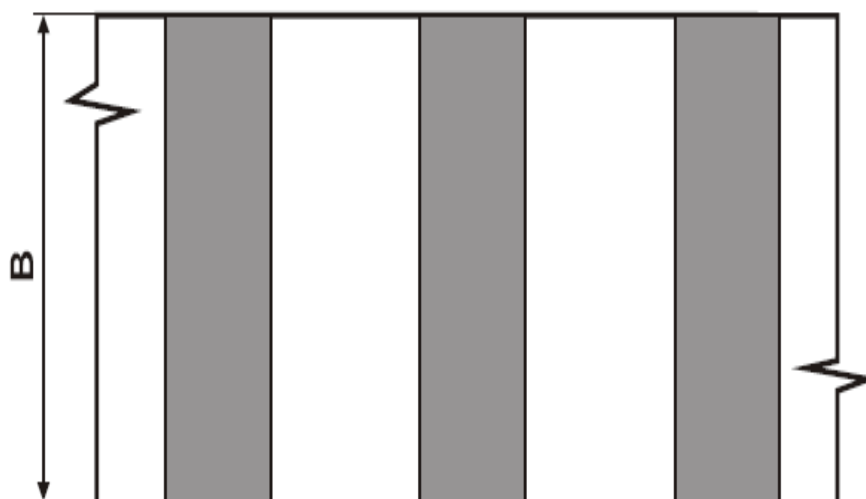
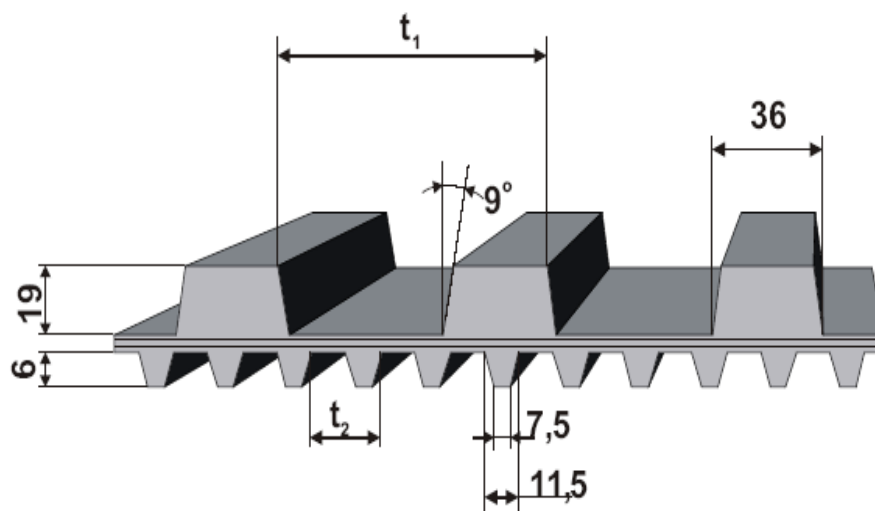

B mm	t <sub>1</sub> mm	t <sub>2</sub> mm
98	86,26	do uzgodnienia

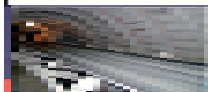

**HandlexPol**

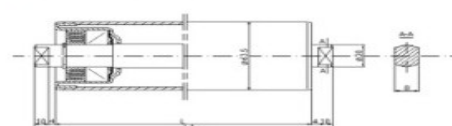
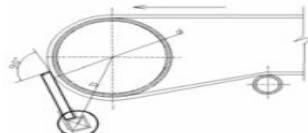
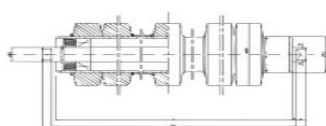

## WZÓR 52 – TAŚMA SPECJALNA

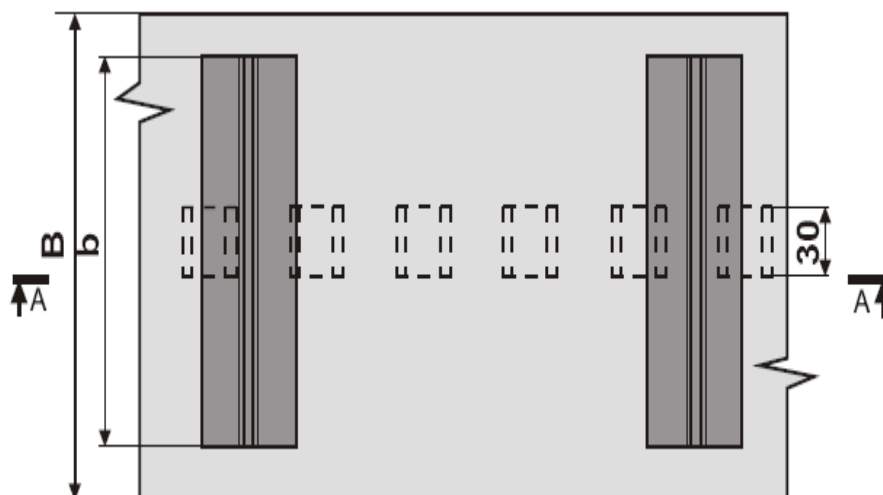
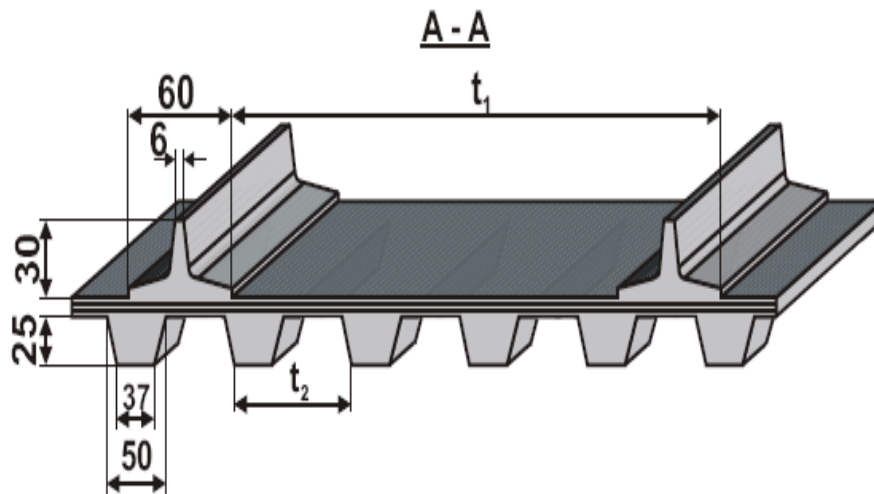

B mm	b mm	t <sub>1</sub> mm	t <sub>2</sub> mm
700	500	381.5	102.7

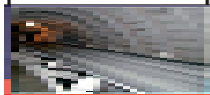

HandlexPol

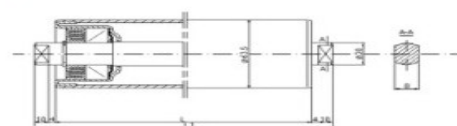
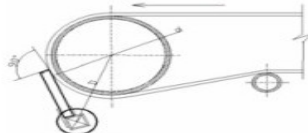
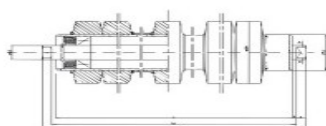



## WZÓR 53 – GUMOWE ELEMENTY MIMOŚRODOWE DO CZYSZCZENIA TAŚM PROFILOWANYCH

